



PERLICK®



MODEL NUMBERS - MOBS-66LE

Tobin Ellis Signature Series Limited Edition Mobile Bar

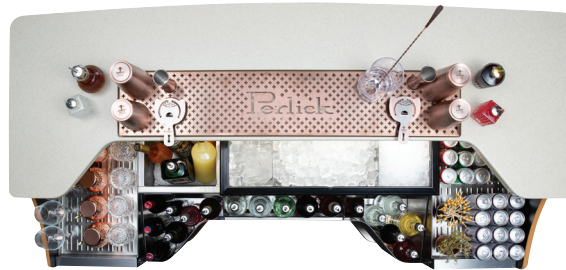

MOBS-66LE-TC-VS-001

JOB	
AREA	
ITEM NO.	
MODEL NO.	

MODELS
MOBS-66LE

THE WORLD'S MOST LUXURIOUS, ERGONOMIC MOBILE BAR

Designed by Tobin Ellis especially for high-volume, upscale venues, this mobile cockpit features a custom, high-performance solid surface "cockpit bar counter" with an 8" deep workboard, and additional ergonomic features for greater bartender comfort, all wrapped in luxurious, sustainable "toffee crocodile" recycled leather.

Quick Features:

- Luxury finishing with sustainable recycled leather in "Toffee Crocodile" selected especially for upscale environments
- Extra-large inlaid 8" deep perforated workboard with a custom antique copper finish keeps bartop clean and dry
- Featuring smooth, rounded edges and corners throughout for added bartender comfort
- Durable solid surface "Vanilla Sugar" finish bar top has been customized shaped to match the cockpit design
- Optimized to an ideal height for all bartenders, male & female, to increase speed and reduce repetitive stress injuries
- Double-drainboard design allows for maximum flexibility for any catering or mobile environment
- One of the only mobile bars ever designed that puts bartender-at-center for true zero-step bartending
- Bar holds up to 27 liters, 36 pieces of glassware, 40 cans or bottles of soda, 3 types of ice, and more depending on set-up
- Ample storage for glass racks, back up cases, bus tubs, and so much more, all hidden from guest line-of-sight
- Designed by Tobin Ellis to leverage his 32 years of high-volume, upscale bartending experience that includes more than 20 years in mobile bar catering for 5-diamond resorts, high-volume Las Vegas nightclubs, and so much more

Form No. Z2647
Rev. 05.13.25



PERLICK®



MODEL NUMBERS - MOBS-66LE

Tobin Ellis Signature Series Limited Edition Mobile Bar

MODEL NOS.		MOBS-66LE
DIMENSIONS: EXTERIOR (mm)	Length	70" (1778)
	Width	34-1/2" (877)
	Height	43-3/4" (1112)
	Weight (lbs)	351 lbs. (159 kg)
DIMENSIONS: SHIPPING (mm)	Length	75" (1905)
	Width	40" (1016)
	Height	70" (1778)
	Weight (lbs)	451 lbs. (205 kg)
PERLICK BAR EQUIPMENT	Ice Chest	TS30IC with sliding Cover
	Insulated Bottle Well	TSC12IBW
	Drainboard	TSCS12 (2 ea.)
	Speed Rail	SRC-CL left curved (1 ea.) SRC-CR right curved (1 ea.) SRC-S18 18" straight (1 ea.)
ELECTRICAL	Voltage	120V AC
	Frequency	60 Hz
	Phase	Single
	Amperage	0.4 A
	Connection	NEMA 5-15P
	Cord Length	12ft
LED BARTENDER TASK LIGHTING	Color Temperature	4000K
	Lumen Output	High - 1200 LM Medium - 800 LM Low - 400 LM
GRAY WATER/ICE MELT TANK (PRE-PLUMBED)	Capacity	5 gal (18.9 L)

**Note: Custom Vinyl wrap graphics available on Perlick Mobile Bar and Tobin Ellis Signature Series Mobile Bar
(Must call Perlick for quote and ordering process)*

Form No. Z2647
Rev. 05.13.25



PERLICK®



MODEL NUMBERS - MOBS-66LE

Tobin Ellis Signature Series Limited Edition Mobile Bar

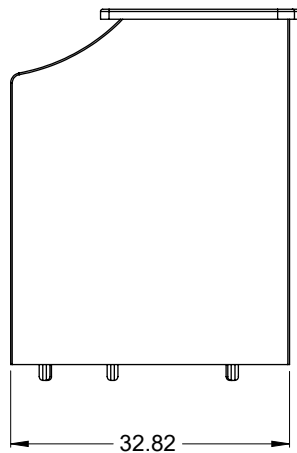
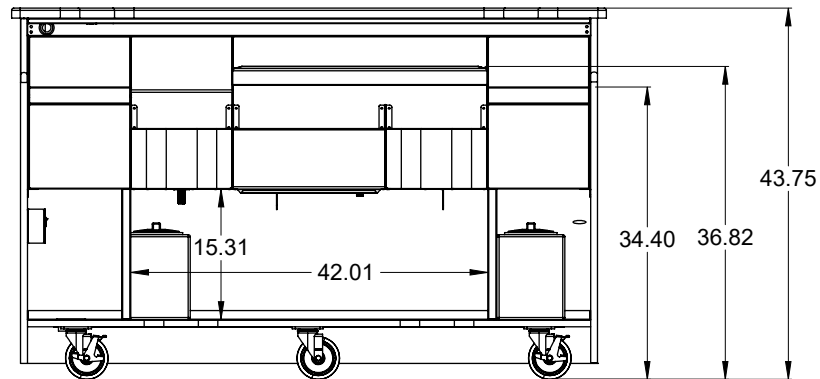
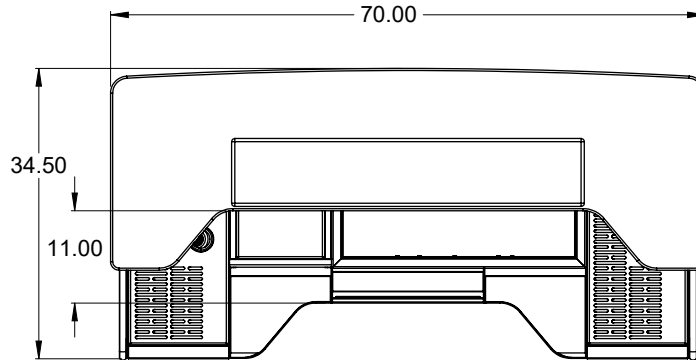

Form No. Z2647
Rev. 05.13.25

Tobin Ellis Signature Series Limited Edition Mobile Bar

MOBS-66TS

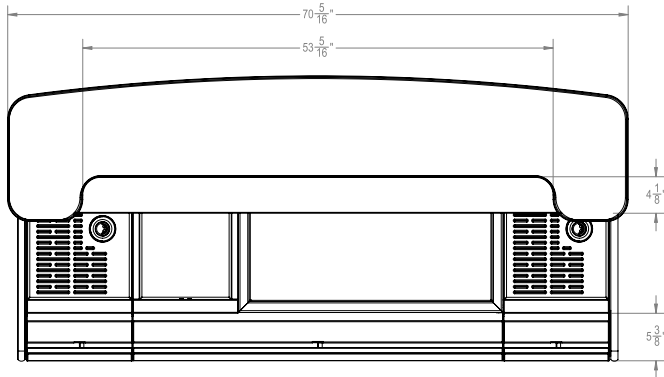

Laminate / Solid Surface Top

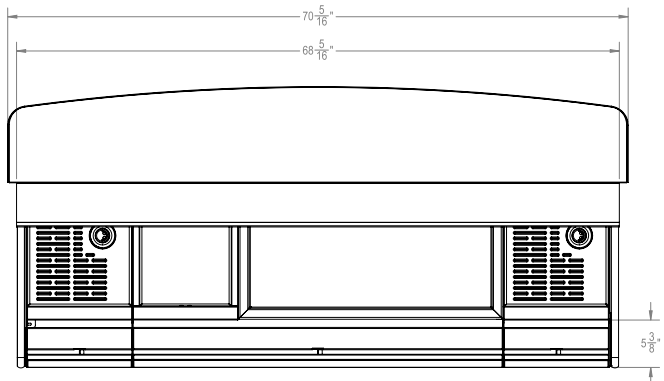

Stainless Steel Top

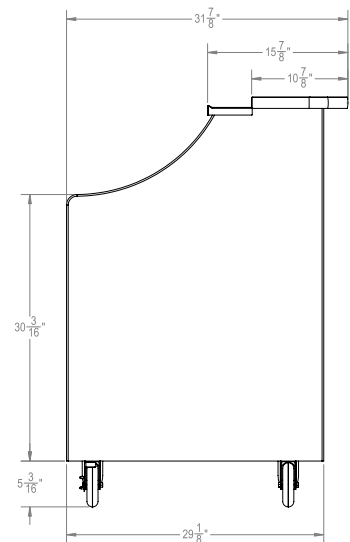
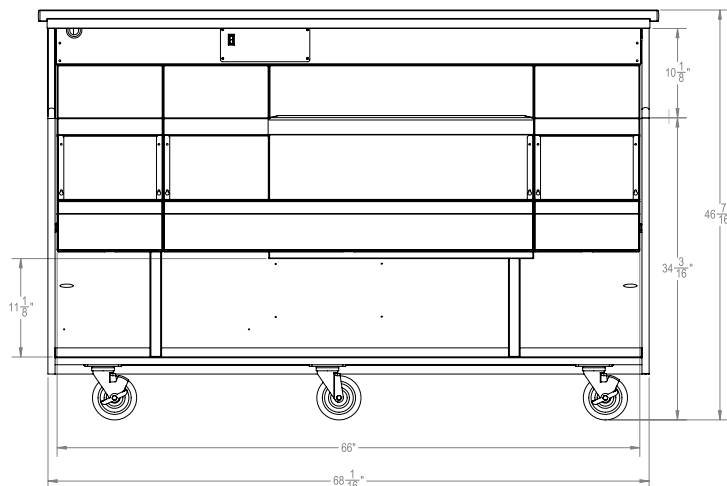

Tobin Ellis Signature Series Limited Edition Mobile Bar

MOBS-66TS-S

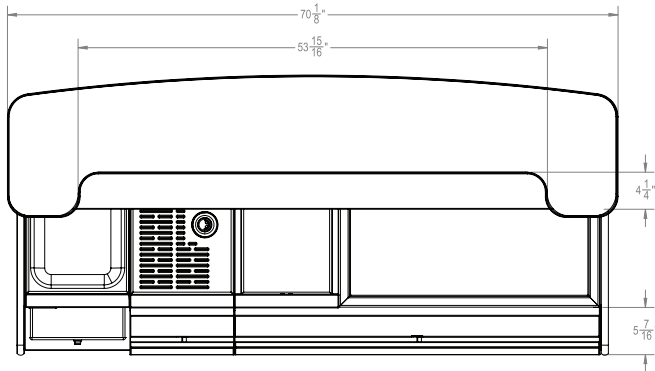

Laminate / Solid Surface Top

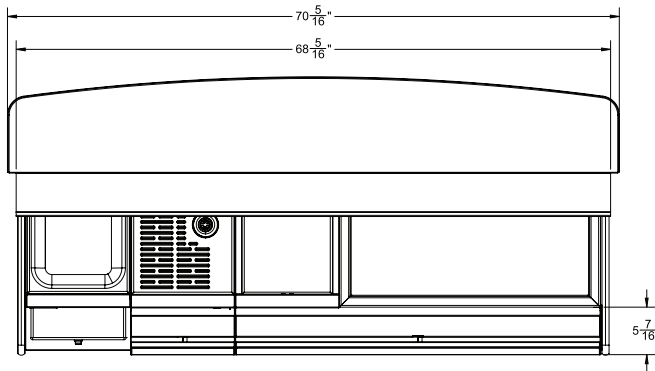

Stainless Steel Top

