

VICTORY[®]

ULTRASPEC

PROJECT: _____

ITEM # _____ QTY: _____

MODEL # _____

AIA # _____ SIS # _____

ROLL-IN FREEZER

ROLL-IN FREEZER

FISA-2D-S1-HC



EXCLUSIVE WARRANTY

- ▶ 7 Year Parts, Labor and Compressor
- ▶ Exclusive 2 Year Warranty On Magnetic Door Gaskets
- ▶ Lifetime Warranty On Handles & Hinges (parts only)

CABINET CONSTRUCTION

- Stainless Steel Exterior
- Aluminum Interior
- Heavy-Duty Cam Hinges
- Stay-Open Door Feature For Easy Product Loading
- Heavy-Duty 20 Gauge Stainless Steel Door
- Heavy-Duty Cylinder Locks
- Stainless Steel Interior Door Liner
- Adjustable Door Wiper Gaskets
- One-Piece, Snap-In Magnetic Door Gaskets
- Low Profile Vertical Door Handles
- Hinged Front Shroud
- Energy Saving Thermal Breaker With Stainless Steel Breaker Caps
- Accepts Cart: 26 1/2"W x 28"D x 65"H (cart not included)
- 8' Cord And Plug (see electrical data for details)

FEATURES

- Full Electronic Control With Touchpoint Interface
- Expansion Valve Technology
- One Touch Defrost
- Manager's Lockout Feature
- High Performance, Balanced, Top-Mounted Refrigeration
- Anti-Condensate Perimeter Heater

REFRIGERATION

- Refrigeration System Uses R-290 Refrigerant To Comply With All Environmental Concerns
- Hot Gas Condensate Evaporator
- Adaptive Defrost For Reduced Energy Consumption And More Consistent Product Temperatures
- Epoxy Coated Evaporator Coil, Located Out Of The Food Zone
- Freezer Capable Of Maintaining Product Temperature -10°F



Please Verify Qualifying Units By Visiting:
www.energystar.gov/cfs

OPTIONS & ACCESSORIES

- Stainless Steel Back
- Stainless Steel Exterior Floor (base)
- Exterior Laminate
- Correctional Facilities Option
- FlexTemp Maintain Between 0°F And 20°F
- Door Swing Orientation (at time of order)

3779 Champion Blvd, Winston-Salem, NC 27105

ph: (888) 845-9800 | fax: (800) 253-5168

Sales@VictoryRefrigeration.com | VictoryRefrigeration.com

Rev. 3/4/25 Printed in U.S.A.

APPROVAL: _____ DATE: _____

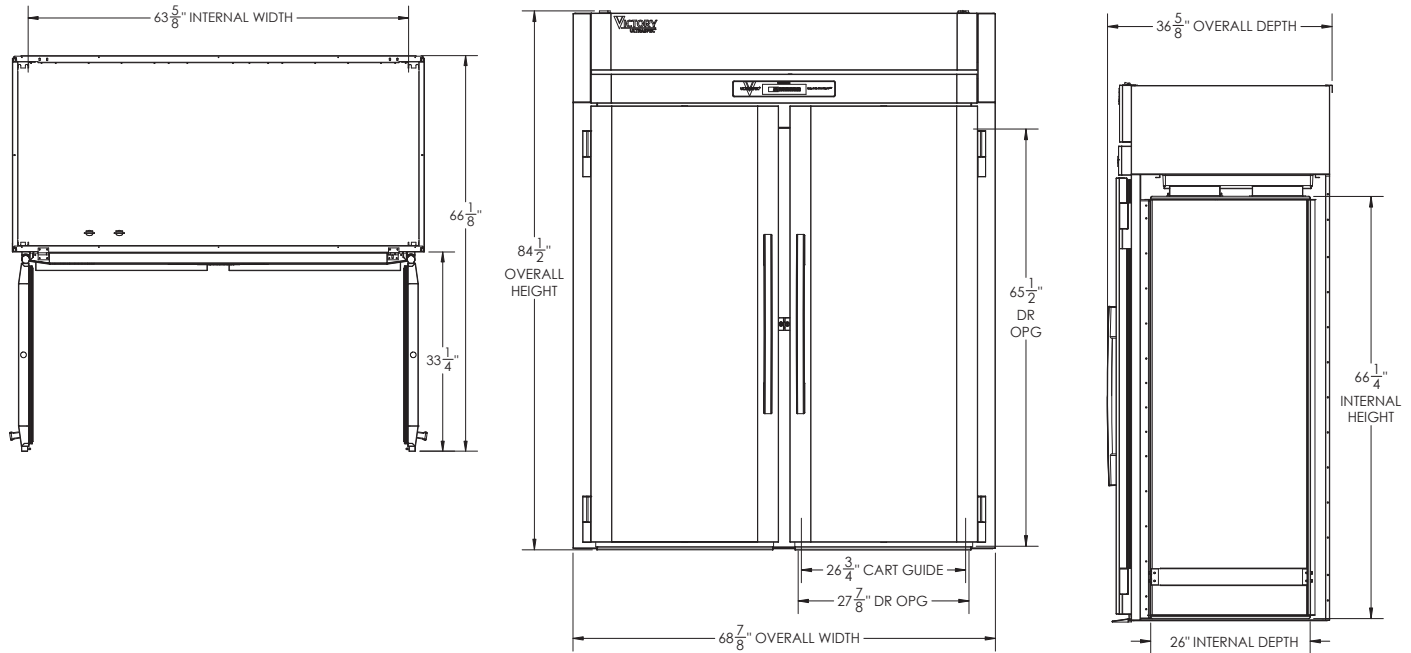

We reserve the right to change specifications and product design without notice. Such revisions do not entitle the buyer to corresponding changes, improvements, additions or replacements for previously purchased equipment. Dimensional tolerances $\pm 1/4$ ". Metric dimensions (MM)

12" Top clearance is required

CHARACTERISTICS		ELECTRICAL DATA		SHIPPING DETAILS	
Net Capacity (cubic ft)	70.84	Cabinet Voltage*	115/60/1	Height	88"
Width, Overall (in.)	68 7/8"	Total Amperes	13.9	Width	77"
Depth, Overall (with handle)	36 5/8"	NEMA Plug (8' cord)	5-20P	Depth	45"
Height Overall	84 1/2"	REFRIGERATION DATA		Crated Weight	682 lbs
Depth, Door Open 90°	66 1/8"	Condensing Unit Size, HP	(2) 3/4		
Door Opening (in.)	27 7/8" x 65 1/2"	Refrigerant	R-290		
No. Of Doors	2	Capacity (BTU/HR) (100°F/-20°F)	4900		
		Heat Rejection (BTU/HR)	7350		
		Charge (lbs/grams/ounces)	0.2866 / 130 / 4.59		

* NOTE: This unit utilizes variable speed compressor technology. The compressor can experience nuisance tripping on Class A GFCI outlets which have a trip limit of 4 mA to 6 mA. To avoid this issue in a location that requires GFCI circuit protection, Victory recommends using either an Eaton, SGF20, or HUBBELL Model Number GFRST83W 20A Heavy Duty Hospital Grade Self-Test GFCI Receptacle.

3779 Champion Blvd, Winston-Salem, NC 27105

ph: (888) 845-9800 | fax: (800) 253-5168

Sales@VictoryRefrigeration.com | VictoryRefrigeration.com

Rev. 3/4/25 Printed in U.S.A.