



KM-161BAK

SELF-CONTAINED CUBER
WITH BUILT-IN STORAGE BIN

KMEDGE™



KM-161BAK
10/28/25
Item # 13551K

W x D x H
23^{3/4}" x 28" x 39"*
*including 6" legs



ADA Compliant



KM-161BAK ★
Air-Cooled



Item #: _____
Project: _____
Qty: _____
AIA#: _____

Features

- ▶ Individual crescent cube
- ▶ Environmentally friendly R290 hydrocarbon refrigerant
- ▶ Stainless steel evaporator

- CycleSaver™ design 
- Up to 156 lbs. of ice production per 24 hours
- Built-in storage capacity of 2.6ft³/78 lbs.*
- Durable stainless steel exterior
- Front-in, front-out airflow with removable air filter
- Slide in door
- 6.5 ft. (2000 mm) power cord with NEMA 5-15P plug
- Power switch accessible without panel removal
- Built-in installation possible
- EverCheck™ alert system 

Warranty:

3 Year Parts & Labor on entire machine. 5 Year Parts & Labor on Evaporator. 5 Year Parts on Compressor; air-cooled condenser coil. Valid in United States, Canada, Puerto Rico and U.S. Territories. Contact factory for warranty in other countries.

Shipping: (LxWxH) 31" x 27" X 39" Volume: 18.89ft³

		ICE PRODUCTION		WATER USAGE		ELECTRICAL						
Condenser	Model	Air / Water Temp Lbs. per 24 hours		Potable	Condenser	kWh Used	Min. Circuit/ Max. Fuse	Amperage	Voltage	Heat Rejection BTU/hr.	Refrigerant Charge Amount	Net / Ship Weight (lbs.)
		70°/ 50°F	90°/ 70°F	Gal. per 100 lbs. 90°/ 70°F	Gal. per 100 lbs. 90°/ 70°F	per 100 lbs. 90°/ 70°F	Size					
Air-Cooled	KM-161BAK	156	125	22.0	N/A	5.5	15A	3.5A	115V/60/1	2,800	3.9 oz.	126 / 161

KMEdge™ Cube Dimensions*

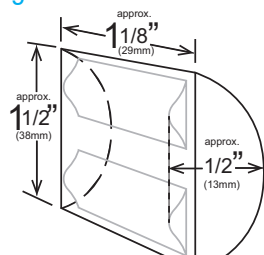

* approximate size in inches, image not to scale

Operating Limits

- Ambient Temp Range 45 - 100°F
- Water Temp Range 45 - 90°F
- Water Pressure 10 - 113 PSIG
- Voltage Range 108 - 122V
- If GFCI is required, a GFCI breaker MUST be used in lieu of GFCI receptacle

Service

- Allow enough space at rear for water supply and drain connections, at least 12" (30 cm) clearance at front and at least 0.6" (15 mm) clearance at top for maintenance.

Plumbing

- Icemaker Water Supply Line: Minimum 1/4" Nominal ID Copper Water Tubing or Equivalent
- Icemaker Drain Line: Minimum 3/4" Nominal ID Hard Pipe or Equivalent

Water Filter

Please refer to water filter spec sheet for recommended configurations.

Hoshizaki reserves the right to change specifications without notice.



KM-161BAK

**SELF-CONTAINED CUBER
WITH BUILT-IN STORAGE BIN**

KM|EDGE™

KM-161BAK
10/28/25
Item # 13551K

mm
[inch]

FRONT VIEW

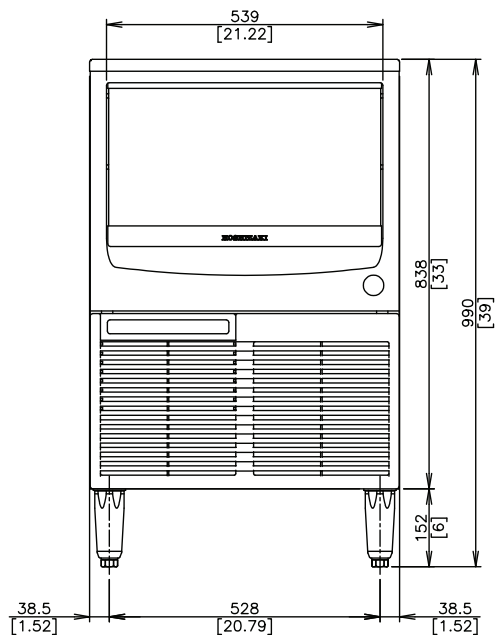

TOP VIEW

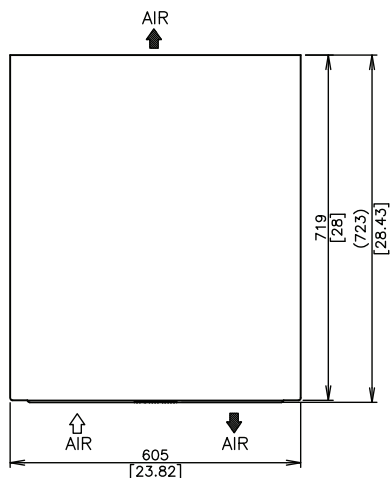

SIDE VIEW

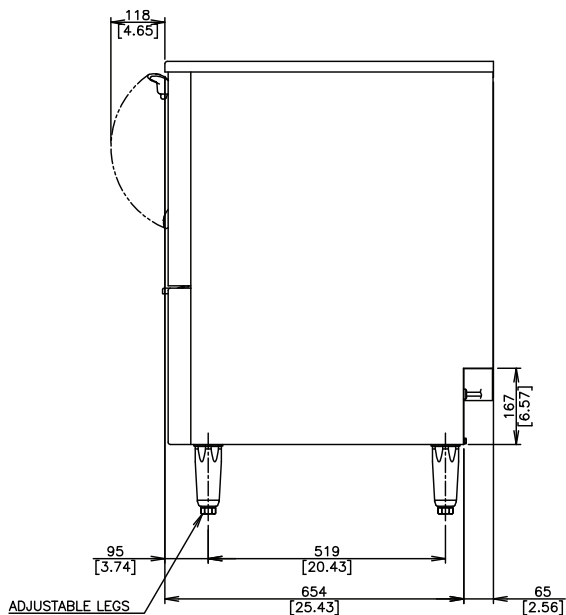

REAR VIEW

