



TRUE MANUFACTURING CO., INC.
RETAIL DIVISION

2001 East Terra Lane • O'Fallon, Missouri 63366-4434 • (636)240-2400
Fax (636)272-2408 • Toll Free (800)325-6152 • Intl Fax# (001)636-272-7546
Parts Dept. (800)424-TRUE • Parts Dept. Fax# (636)272-9471 • www.truemfg.com

Project Name: _____

Location: _____

Item #: _____ Qty: _____

Model #: _____

A/A #

S/S #

Model:

CVM-20-HC~EGC01

Contemporary Visual Merchandiser:

Swing Door Refrigerator with Hydrocarbon Refrigerant~Edge Glass Curved Version 01



FEATURES

With its curved edge design and increased beverage storage, the series redefines merchandising.

The curved-edged door design has a built-in handle for opening the door from the top or side.

Illuminated handle position indicator.

Uses environmental friendly R290 Hydrocarbon refrigerant.

Energy efficient, factory balanced, refrigeration system holds 33°F to 38°F (.5°C to 3.3°C).

Self-Cleaning RCU Technology eliminates the need for cleaning of condenser coil, reduces energy consumption and helps maintain the coldest temperature and freshest product.

Exterior digital temperature display.

ROUGH-IN DATA

Specifications subject to change without notice.
Chart dimensions rounded up to the nearest 1/8" (millimeters rounded up to next whole number).

Model	Doors	Shelves	Cabinet Dimensions (inches) (mm)			HP	Voltage	Amps	NEMA Config.	Cord Length (total ft.) (total m)	Crated Weight (lbs.) (kg)
			W	D†	H						
CVM-20-HC~EGC01	1	6	27 686	24½ 623	78½ 1994	¼ N/A	115/60/1	3.4 N/A	5-15P	10 3	320 146

† Depth does not include 5/8" (16 mm) for rear mechanical components.



APPROVALS:

AVAILABLE AT:

07.25

Printed in U.S.A.

Model:

CVM-20-HC~EGC01

Contemporary Visual Merchandiser:

Swing Door Refrigerator with Hydrocarbon Refrigerant~Edge Glass Curved Version 01

True®

STANDARD FEATURES

DESIGN

- True's Contemporary Series is built with durability, stability, and style in mind. Through the series' curved edge design it redefines merchandising with its inspired product displays and increased beverage storage.

REFRIGERATION SYSTEM

- Factory engineered, self-contained, capillary tube system using environmentally friendly R290 hydrocarbon refrigerant that has zero (0) ozone depletion potential (ODP), & 0.02 global warming potential (GWP).
- High capacity, factory balanced refrigeration system that maintains cabinet temperatures of 33°F to 38°F (.5°C to 3.3°C) for the best in food preservation.
- State of the art, electronically commutated evaporator and condenser fan motors. ECM motors operate at higher peak efficiencies and move a more consistent volume of air which produces less heat, reduces energy consumption and provides greater motor reliability.
- NSF/ANSI Standard 7 compliant for the storage and/or display of packaged or bottled product.

CABINET CONSTRUCTION

- Exterior - non-peel or chip black powder coated cold rolled steel; durable and permanent.
- Welded, heavy duty steel frame rail, black powder coated for corrosion protection. Frame rail fitted with leg levelers.

- Interior - attractive, black aluminum interior liner with stainless steel floor.
- Insulation - entire cabinet structure is foamed-in-place using a high density, polyurethane insulation that has zero ozone depletion potential (ODP) and 0.02 global warming potential (GWP).
- Door sign decal. Variety of decal options available.

DOOR

- The curved-edged door design has a built-in handle for opening the door from the top or side.
- "Low-E", double pane thermal insulated glass door assembly with mitered plastic channel frame. The latest in energy efficient technology.
- Features an integrated LED handle indicator.
- Self closing door. Positive seal, torsion type closure system.
- Magnetic door gasket of one piece construction, removable without tools for ease of cleaning.
- Edge of door will remain black when an alternative exterior or interior color finish is ordered.

SHELVING

- Six (6) adjustable, heavy duty PVC coated wire shelves 22 15/32" L x 18 1/4" D (571mm x 464mm). Four (4) shelf clips included per shelf.

- Shelf support pilasters made of same material as cabinet interior; shelves are adjustable on 1/2" (13mm) increments.

LIGHTING

- LED interior lighting, safety shielded.

ELECTRICAL

- Unit completely pre-wired at factory and ready for final connection to a 115/60/1 phase, 15 amp dedicated outlet. Cord and plug set included.



115/60/1
NEMA-5-15R

OPTIONAL FEATURES/ACCESSORIES

Upcharge and lead times may apply.

- ☐ White exterior.
- ☐ Stainless steel interior and exterior.
- ☐ White aluminum interior liner with white shelving.
- ☐ 2 1/2" (64 mm) diameter castors.
- ☐ 4" (102 mm) diameter castors.
- ☐ 6" (152 mm) legs.
- ☐ 6" (152 mm) seismic flanged legs.
- ☐ Red wine thermostat.
- ☐ White wine thermostat.
- ☐ Chocolate thermostat.
- ☐ Additional shelves.
- ☐ TrueFlex gravity feed organizers.
- ☐ Pricing strips.
- ☐ Left door hinging available.

PLAN VIEW

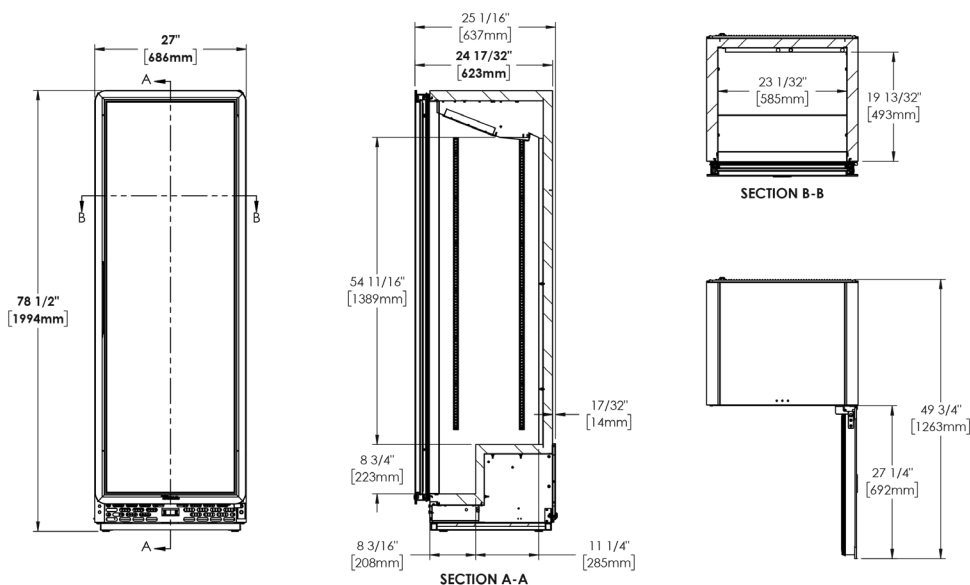

METRIC DIMENSIONS ROUNDED UP TO THE NEAREST WHOLE MILLIMETER

SPECIFICATIONS SUBJECT TO CHANGE WITHOUT NOTICE



Model	Elevation	Right	Plan	3D	Back
CVM-20-HC~EGC01					

TRUE MANUFACTURING CO., INC.

2001 East Terra Lane • O'Fallon, Missouri 63366-4434 • (636)240-2400 • Fax (636)272-2408 • Toll Free (800)325-6152 • Intl. Fax# (001)636-272-7546 • www.truefmfg.com