

## TT/TT2

Mobile Open Frame Tray And Rack Dispensers

### Models

- TT-1014 One stack, 11"x15" trays
- TT2-1014 Two stack, 11"x15" trays
- TT2-1826 Two stack, 18"x26" trays



TT-1014

### Standard Features

- Tubing and base to be 16-gauge stainless steel
- Tubing and base to be integrally welded
- Base to be reinforced with 14-gauge stainless steel angles
- Non-marring gray corner bumpers
- (4) 4.00" diameter Polyurethane swivel casters (all locking)
- Dispenser platform carrier shall be 18-gauge stainless steel
- Self-leveling mechanisms shall be adjustable by adding and removing stainless steel extension springs located inside the elevator housing
- Each dispenser section holds approximately 50-60 trays (varies per tray style)
- One year parts and 90 day labor standard warranty

### Options & Accessories

- Flange-mount feet in lieu of casters
- Napkin dispensers
- Six- or eight-hole silverware bins with plastic or stainless steel cylinders
- Wrap-around bumpers (adds 1.75" [4.4cm] to overall length and depth)
- Dust cover

### Specifications

**Framework** shall be integrally welded 1.00" (2.5cm) O.D. 16-gauge stainless steel tubing welded to a 16-gauge stainless steel base. Frame shall have stainless steel horizontal support rods affixed to the tubing. Base shall be reinforced with full-length 14-gauge stainless steel angles.

**Castors:** Unit shall have four 4.00" (10.2cm) diameter Polyurethane swivel casters (all locking) (5.00" [12.7cm] ride height) and non-marking gray bumpers at each corner.

**Dispenser** platform carries shall be 18-gauge stainless steel and shall be removable for cleaning. Each dispenser shall have 2 self-leveling mechanisms.

**Self-leveling** mechanisms shall be field adjustable by adding or removing stainless steel extension springs located inside the elevator housing.



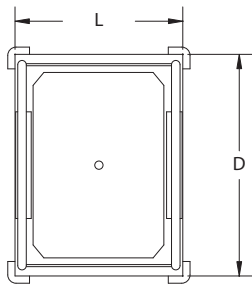

**Plan View  
TT Models**

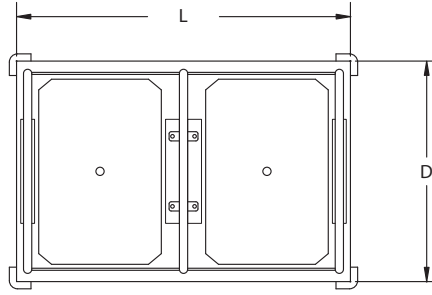

**Plan View  
TT2 Models**

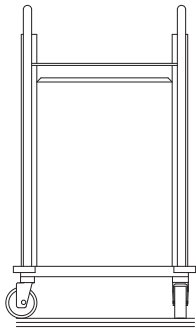

**Elevation View  
TT Models**

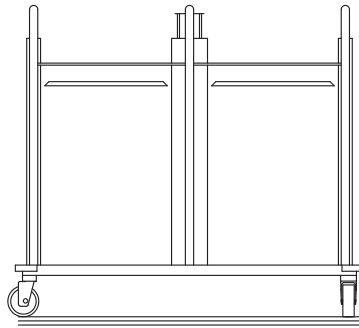

**Elevation View  
TT2 Models**

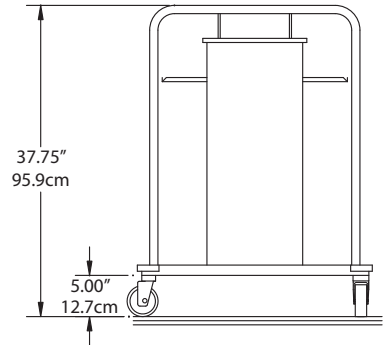

**Right End View  
All TT & TT2 Models**

Specifications				
Model	Length	Depth	Maximum Tray Size	Ship Weight
TT-1014	21.25" (54.0cm)	15.25" (38.7cm)	11" x 15" (27.9cm x 38.1cm)	102lbs/46kg
TT2-1014	21.25" (54.0cm)	26.75" (67.9cm)	11" x 15" (27.9cm x 38.1cm)	113lbs/51kg
TT2-1826	48.50" (123.2cm)	30.75" (78.1cm)	18" x 26" (45.7cm x 66.0cm)	179lbs/81kg

**NOTES:**

- Standard corner bumpers add 1.75" (4.4cm) to overall length and width.
- TT2 models dispense two separate stacks of trays.

TT/TT2

Mobile Open Frame Tray And Rack Dispensers

Delfield reserves the right to make changes to the design or specifications without prior notice.