

## Cuisine Series Heavy Duty Plancha Top Range

Project \_\_\_\_\_  
 Item \_\_\_\_\_  
 Quantity \_\_\_\_\_  
 CSI Section 11400  
 Approved \_\_\_\_\_  
 Date \_\_\_\_\_

### Models

- C24-19S
- C24-19M



Model C24-19S  
 24" Plancha  
 (shown with optional door)

### Standard Features

- 20,000 BTU/h (NG) burners
- 5/8" (16mm) thick steel plate plancha
- Stainless steel front and sides
- Stainless steel front rail
- 1-1/4" NPT front gas manifold
- Can be installed individually or in a battery
- 7" (178mm) high stainless steel stub back
- 6" (152mm) stainless steel adj. legs
- Modular unit (M) can be mounted on Polar Cuisine refrigerated base

### Options & Accessories

- Single or double deck high shelf or back riser
- Full-height stand for modular base with legs or casters
- Stainless steel intermediate shelf for cabinet base
- Stainless steel door(s) for cabinet base units
- Stainless steel back
- Continuous plate rail, 48"-72" for battery installations
- Gas shut-off valves: 3/4", 1", 1 1/4" NPT (Specify)
- Gas regulator: 3/4", 1", 1 1/4" NPT (Specify)
- Gas flex hose w/ quick disconnect: 3/4", 1", 1 1/4" (Specify)
- Rear gas connection: 3/4" NPT
- Set of (4) flanged feet (for fastening unit to the floor)
- Set of (4) 5" polyurethane non-marking swivel casters w/front brakes
- Set of (4) 6" swivel casters w/front brakes
- Extension for 1/9 pans

### Specifications

Garland Cuisine 24" (610mm) wide Heavy Duty Range Series. Model \_\_\_\_\_ with total BTU/h rating of \_\_\_\_\_ when used with natural/propane gas. Stainless steel front and sides. 6" (152mm) legs with adjustable feet.

**Plancha** - 5/8" (16mm) thick steel plate plancha griddle with  
 3" (76mm) wide grease trough. Burners rated 20,000 BTU/h each. One burner per 12" (305mm) griddle section.

NOTE: Ranges supplied with casters must be installed with an approved restraining device.



Cuisine Series Heavy Duty Plancha Top Range

Cuisine Series Heavy Duty Plancha Top Range

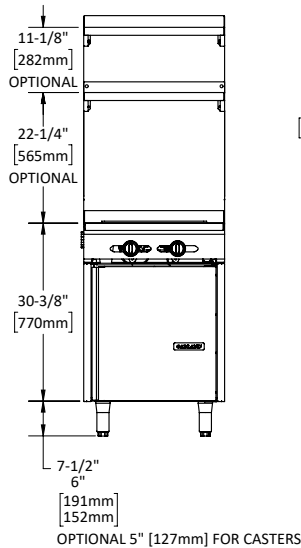
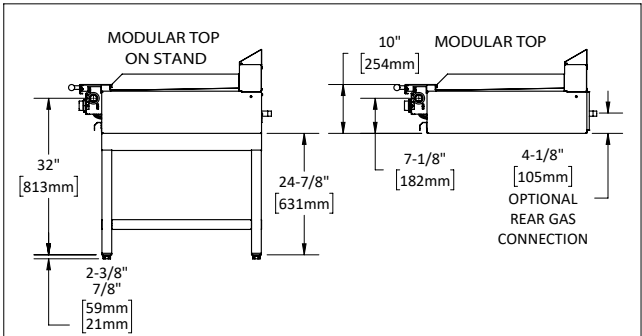
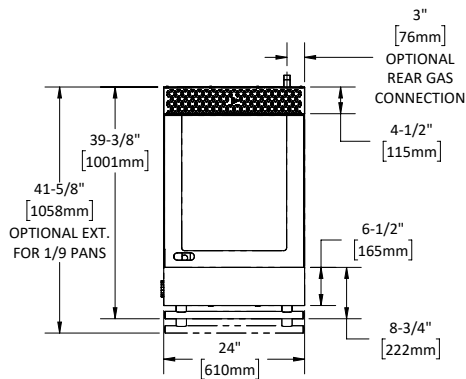

CURB/DAIS MOUNTING

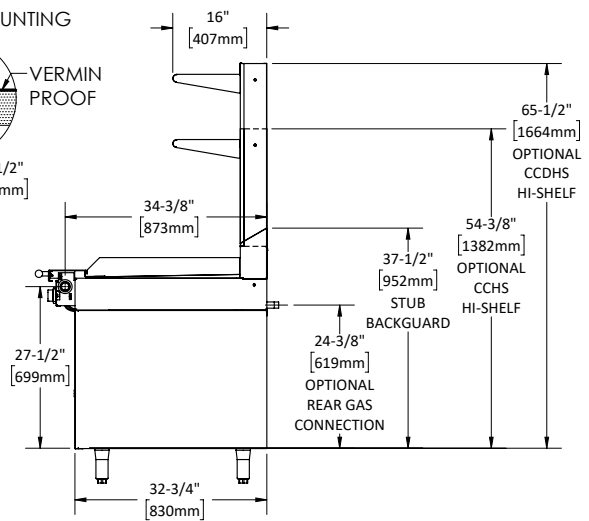
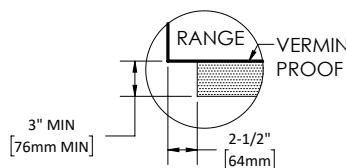

Model #	Description	Total BTU/h NAT. Gas	Total BTU/h Propane	Shipping		Individual Burner Ratings (BTU/h)		
				Cu Ft	lbs/kg	Burner	NAT.	PRO.
C24-19S	24" Plancha - w/Storage Base	40,000	38,000	35	380/172	Plancha Griddle	20,000	19,000
C24-19M	24" Plancha - w/Modular Top	40,000	38,000	35	342/155	Interior Dimensions: In (mm)		
						Product	Height	Width
						Cabinet Base	20-1/2 (521)	32-1/4 (819)
							Depth	31 (787)

Combustible Wall Clearance	
Sides	Back
10" (254mm)	6" (152mm)

Gas Pressure	NAT.	PRO.
Minimum Supply	7" WC	11" WC
Manifold Operating Pressure	6" WC	10" WC
Gas Manifold 1-1/4" NPT		

Garland reserves the right to make changes to the design or specifications without prior notice.