

RackStar® 66ER

Rack Conveyor Dishwasher with
Energy Recovery

Standard Features

- Energy Recovery
- WISR® cleaning system
- Built-in 24kW booster heater
- 22" pre-wash
- Self-cleaning wash arms
- Adjustable rinse system
 - Econo uses 0.38 gallons per rack
 - Turbo uses 0.65 gallons per rack
- Rainbow Rinse™ with arched rinse arm design
- Automatic tank fill
- Digital LED display
- Delime cycle
- 19 3/4" (502 mm) vertical chamber clearance
- Adjustable vent cowl collars
- Exclusive EnergyGuard™ controls
- Hinged doors provide large front access for ease of cleaning and maintenance
- Double-wall insulated doors
- Stainless steel strainer pans
- Splash shields
- Strike plate table limit switch
- Self-draining stainless steel wash pump
- Built-in pressure regulator
- Vent fan control shuts vent fan off when machine is idle
- Stainless steel front dress panel
- Durable stainless steel construction
- Requires some assembly

Options & Accessories

- | | |
|--|---|
| <ul style="list-style-type: none"> ➤ 460V Electrical ➤ Higher than Standard Hood (25") ➤ Single Phase ➤ Single Point Connection ➤ Drain Water Tempering Kit* ➤ Water Hammer Arrestor ➤ Flanged Feet ➤ Security Package ➤ Scaltrol | <ul style="list-style-type: none"> ➤ Replacement Cartridge for Scaltrol ➤ 36-Compartment Rack <ul style="list-style-type: none"> 4-1/8" tall (105 mm) 5-5/8" tall (143 mm) 7" tall (178 mm) ➤ Combination Rack ➤ Peg Rack ➤ Sheet Pan Rack |
|--|---|



RackStar® 66ER

Specification Statement

Specified unit will be a Jackson RackStar 66 high temperature sanitizing rack conveyor dishwasher with energy recovery, rated by ETL Sanitation to NSF/ANSI Standard 3. Unit will be ENERGY STAR® certified. Unit will be a 44" single tank unit with a 22" pre-wash. Unit to be rated for 224 racks per hour, with adjustable rinse system featuring Econo Rinse using 0.38 gallons per rack and Turbo Rinse using 0.65 gallons per rack. Unit includes WISR® cleaning system with self-cleaning wash arms, Rainbow Rinse™ with arched rinse arm design, and built-in 24kW booster heater. Features include digital LED display, EnergyGuard™ controls, 19 3/4" vertical chamber clearance, automatic tank fill, hinged double-wall insulated doors, self-draining 3.0 HP stainless steel wash pump motor, and vent fan control. Constructed of durable stainless steel with available flanged feet option.

1-year parts and labor warranty.

Mandatory Specs

- Voltage_____
- Direction of Operation
 - ☐ Left to Right
 - ☐ Right to Left



Less Water. Jackson maintains one of the lowest water usages in the conveyor class with the RackStar. The RackStar delivers superior results, using only 0.38 gallons of water per rack.

Less Chemicals. Lowering water usage also reduces the amount of chemicals required in each cycle, saving the operator on chemical costs. The RackStar provides one-pass cleaning, which also minimizes chemical usage by getting the ware *Clean the First Time*®.

Less Energy. By using less water, the RackStar utilizes smaller tank and booster heaters, which lowers overall energy costs for years to come. In addition, the insulated doors retain heat, keeping wash water hot and generating less heat in the dish room.



PRODUCT	RACKS/HOUR	GALLONS/RACK	GALLONS/HOUR	BOOSTER HEATER 70 °F
Brand H	202	0.45	91	18kW
Brand C	209	0.48	100	21kW
Brand S	223	0.65	145	24kW
RackStar	224	0.38	85	24kW

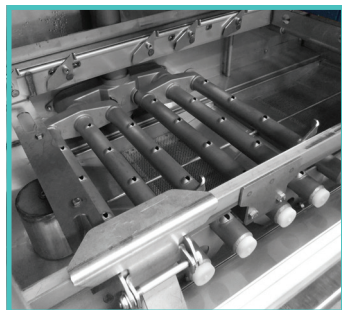

Dual Pawl Bar provides easier access to scrap baskets and better balance to the rack as it is conveyed through the machine.

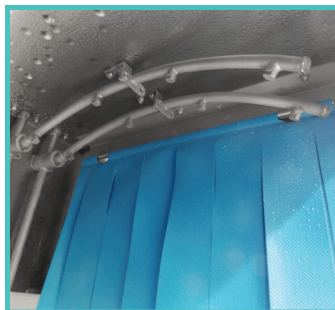

Adjustable Rinse
Econo Rinse uses only 0.38 gallons per rack and is suitable for normal operations. Turbo Rinse uses 0.65 gallons per rack and is ideal for heavier soiled loads.



Hinged Doors provide easy access into the wash chamber for cleaning and maintenance.



Digital LED Controls are easy to read and feature an LED display that communicates temperature, status, and cycle selection.

Right to Left

LEGEND

- A - Electrical Connection
- B - Water Inlet
(1/2" NPT, 110 °F MIN (24 kW Booster))
- C - Drain Connection
(1 1/2" NPT)
- D - Vent Connections
(Including Dampers)
- E - Energy Recovery Water Inlet
(1/2" NPT, 55 °F MIN)
- — — — — - Open Door
- - High Hood Option

All dimensions from the floor can be increased 1 3/4" using the machine's adjustable feet.

Items in red are not supplied with the machine.

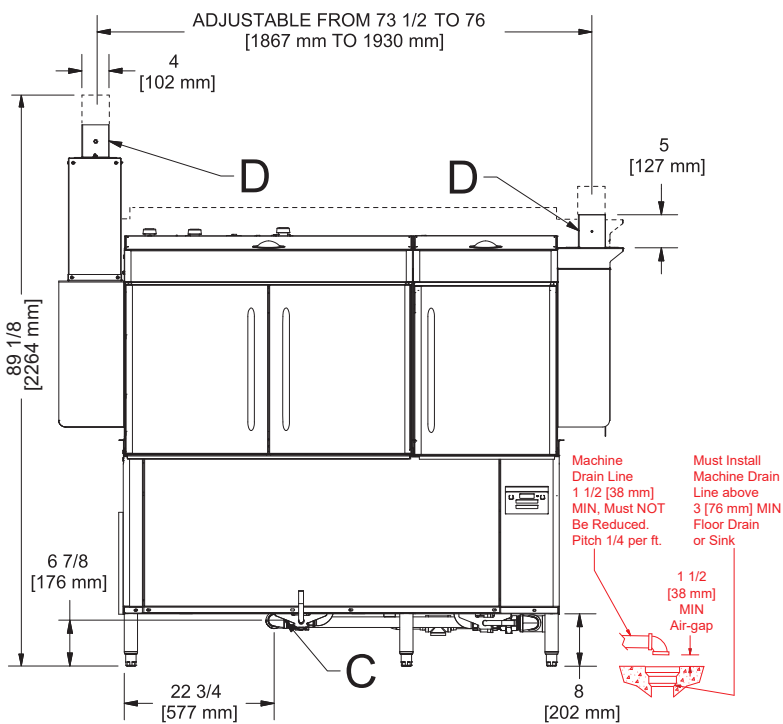
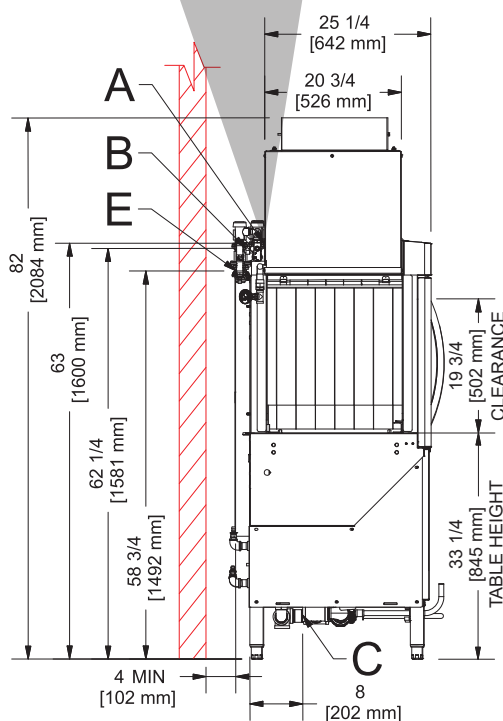
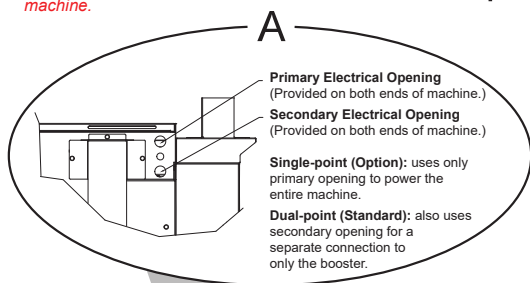
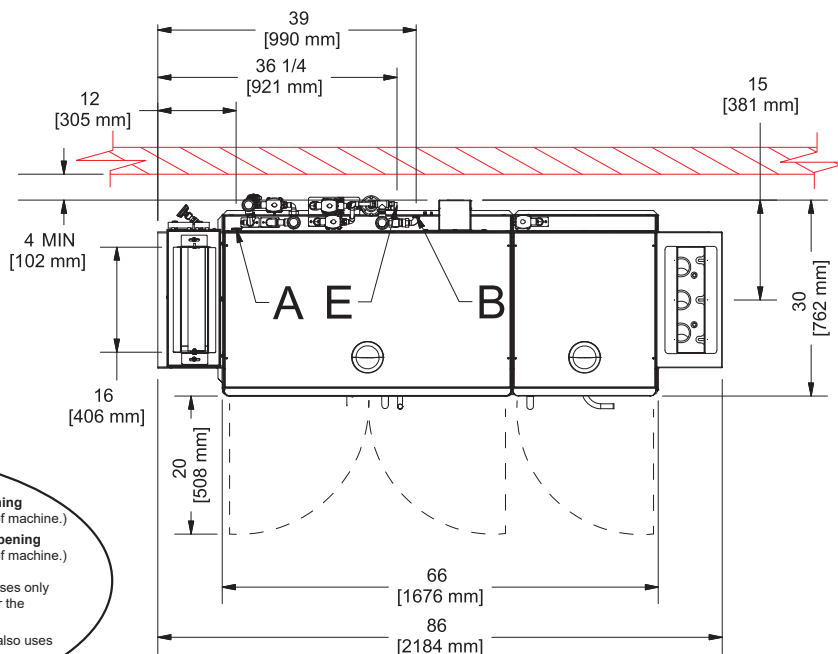

Machine Drain Line 1 1/2 [38 mm] MIN, Must NOT Be Reduced. Pitch 1/4 per ft.

Must Install Machine Drain Line above 3 [76 mm] MIN Floor Drain or Sink

1 1/2 [38 mm] MIN Air-gap

Left to Right

LEGEND

- A - Electrical Connection
- B - Water Inlet
(1/2" NPT, 110 °F MIN (24 kW Booster))
- C - Drain Connection
(1 1/2" NPT)
- D - Vent Connections
(Including Dampers)
- E - Energy Recovery Water Inlet
(1/2" NPT, 55 °F MIN)

— — — — — Open Door

----- High Hood Option

All dimensions from the floor can be increased 1 3/4" using the machine's adjustable feet.

Items in red are not supplied with the machine.

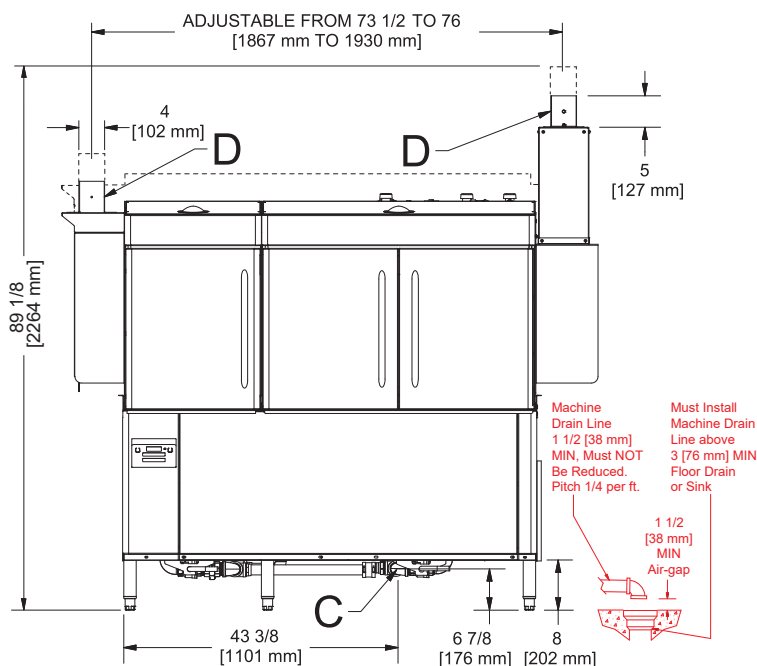
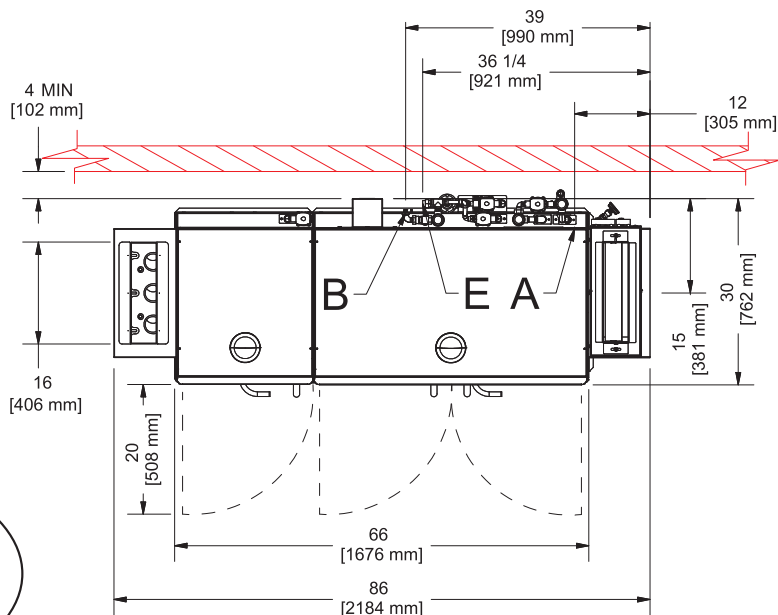
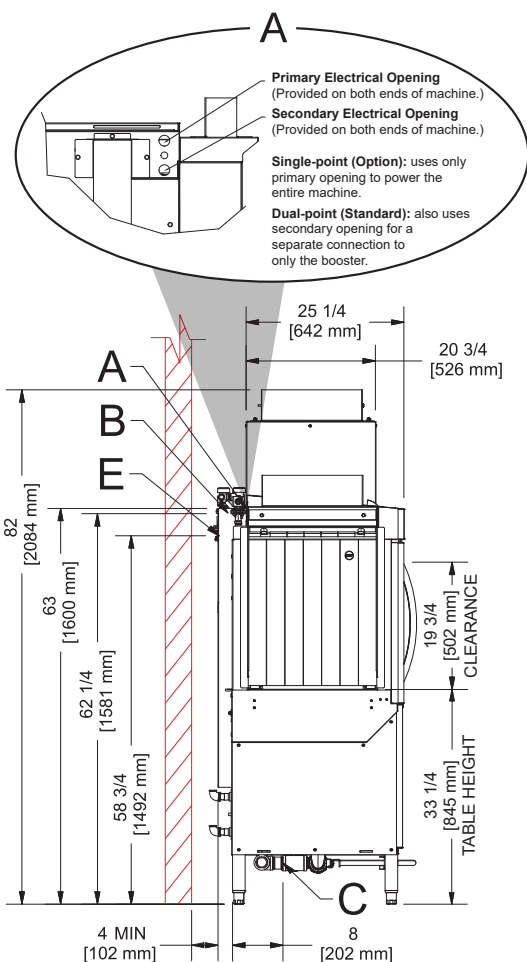

RECOMMENDED TABLE FABRICATION

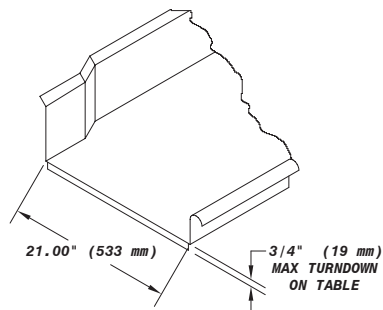
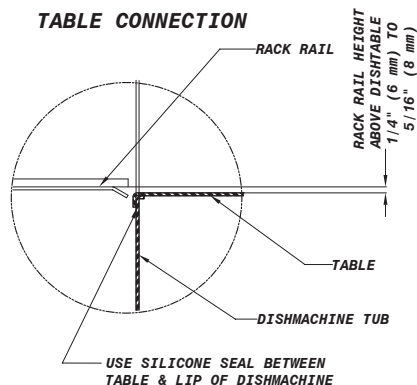

TABLE CONNECTION



Operating Capacity

Racks per Hour	224
Dishes per Hour	5,600
Glasses per Hour	8,064

Operating Speed

Conveyor Speed (feet per minute)	6.10 (1.86 MPM)
----------------------------------	-----------------

Operating Temperature

Pre-wash Temperature	110-140 °F (43-60 °C)
Wash Temperature (minimum)	160 °F (71 °C)
Rinse Temperature (minimum)	180 °F (82 °C)

Water Consumption

Gallons per Rack	
Econo Rinse	0.38 (1.4 L)
Turbo Rinse	0.65 (2.5 L)
Gallons per Hour	
Econo Rinse	85.12 (322.2 L)
Turbo Rinse	145.60 (551.2 L)
Wash Tank Capacity (gallons)	25.00 (94.6 L)
Pre-wash Pump Capacity	220 GPM (833 LPM)
Wash Pump Capacity	270 GPM (1,022 LPM)

Water Requirements

Incoming Water Temperature	110 °F (43 °C)
Flow Pressure (PSI)	20 ± 2
Incoming Water Connection (NPT)	1/2"
Drain Connection (NPT)	1 1/2"

Electrical Specifications

Pre-wash Pump Motor (HP)	2.0
Wash Pump Motor (HP)	3.0
Drive Motor (HP)	1/4
Wash Tank Heater (kW)	15.0
Rinse Tank Heater (kW)	24.0

Venting Requirements (CFM)

Input End	200
Output End	200
Total	400

Dimensions

Width	86" (2184 mm)
Depth	30" (762 mm)
Depth with Door Open	50" (1270 mm)
Height	
Standard	82" (2084 mm)
High Hood	89 1/8" (2264 mm)
Inside Clearance Height	
Standard	19 3/4" (502 mm)
High Hood	25" (635 mm)
Wall Clearance	4" (102 mm)
Drain Height	6 7/8" (175 mm)
Weight	
Standard	1,108 lbs (503 kg)
High Hood	1,123 lbs (509 kg)

Shipping Details

Shipping Weight	
Standard	1,193 lbs (541 kg)
High Hood	1,208 lbs (548 kg)
Shipping Width	96" (2438 mm)
Shipping Depth	40" (1016 mm)
Shipping Height	75" (1905 mm)
Shipping Cube	166.67 cu ft
Shipping Class	150

Single Point Connection

Power Supply	Total Load	Minimum Circuit Ampacity	Maximum Overcurrent Protection
208/60/3	124.8 A	127.1 A	135.0 A
230/60/3	105.8 A	108.0 A	115.0 A
460/60/3	53.1 A	54.2 A	55.0 A
208/60/1	212.6 A	216.0 A	225.0 A
230/60/1	178.5 A	181.5 A	190.0 A

Dual Point Connection

Power Supply	Total Load	Minimum Circuit Ampacity	Maximum Overcurrent Protection
208/60/3 Unit	58.1 A	60.4 A	65.0 A
208/60/3 Booster	66.6 A	67.9 A	70.0 A
230/60/3 Unit	50.5 A	52.6 A	60.0 A
230/60/3 Booster	55.3 A	56.6 A	60.0 A
460/60/3 Unit	25.4 A	26.5 A	30.0 A
460/60/3 Booster	27.7 A	29.0 A	30.0 A
208/60/1 Unit	97.2 A	100.6 A	110.0 A
208/60/1 Booster	115.4 A	116.7 A	120.0 A
230/60/1 Unit	82.6 A	85.7 A	95.0 A
230/60/1 Booster	95.8 A	97.1 A	100.0 A

Advisory: Jackson WWS, Inc. DOES NOT endorse "Tankless On-Demand" water heaters for use with our dishmachines. Jackson WWS, Inc. DOES endorse, and highly recommends, standard "tank" style water heaters, sized to properly handle the water heating requirements of the facility.

CONTACT JACKSON

07610-004-43-17 [07/21/25]

Address

 6209 N U.S. Highway 25E
 Gray, Kentucky 40734

Website
www.jacksonwws.com
Telephone & Fax

 T 888.800.5672
 F 606.523.1799

Email
customer.service@jacksonwws.com

@JACKSONWWS



JACKSON WWS



JACKSON WAREWASHING SYSTEMS



@JACKSONWAREWASHING