



DI-IB24-CP10



Intertek

4004503

Conforms to NSF/ANSI STD 2

Project: _____	AIA# _____
Item #: _____ Qty: _____	SIS# _____
Model #: _____	

Drop-In Ice Bins

DI-IB	DI-IB12, DI-IB18, DI-IB24, DI-IB30, DI-IB24-CP10, DI-IB30-CP10
--------------	---

Standard Features

- Stainless steel top and interior liner
- PVC plastic breaker strip around ice bin liner: creates 5/16" raised edge around liner, acts as thermal barrier to prevent heat transfer, and makes the cover slide easier
- Sliding stainless steel cover
- Eco friendly foamed-in-place insulation has zero impact on global warming or ozone depletion
- Galvanized steel exterior wrap
- 10-1/2" deep liner
- Ten circuit cold plates are optional (add suffix '-CP10' to model number)

Specifications

Drains

- Non-cold plate model: 1-1/2" tailpiece
- Ten circuit cold plate model '-CP10': 3/4" MPT

Cover

- Two piece sliding, stainless steel, included with all models

Cold Plate

- Ten circuit available for DI-IB24 or DI-IB30
- Connection is 5/16" O.D. stainless steel tubing with swaged end

Liner Depth

- 10-1/2"

Ice Capacity

- DI-IB12 - 33 lbs
- DI-IB18 - 50 lbs
- DI-IB24 and DI-IB24-CP10 - 71 lbs
- DI-IB30 and DI-IB30-CP10 - 89 lbs

Cut-out Dimensions

- Model DI-IB12... 17-1/2" by 12-1/2"
- Model DI-IB18... 17-1/2" by 18-1/2"
- Model DI-IB24... 17-1/2" by 24-1/2"
- Model DI-IB30... 17-1/2" by 30-1/2"

Materials

- 22 gauge galvanized steel parts include: exterior wrap and bottom
- 20 gauge stainless steel parts include: top, interior liner, and sliding cover. The reinforced top consists of two layers.

To view underbar installation instructions, please visit:

https://www.glastender.com/PDF/F-750-165_Underbar_Installation_Instructions.pdf

To view cleaning and care instructions, please visit: https://www.glastender.com/PDF/F-423-011_ss_clean_care.pdf

Glastender, Inc. • 5400 N Michigan Rd • Saginaw, MI • 48604-9780 989.752.4275 • 800.748.0423 • Fax 989.752.4444 www.glastender.com	Approval/Notes:
Specifications subject to change without notice. For current specifications please visit our website.	

Drop-In Ice Bins

Dimensional Information

DI-IB12

Cut-out size:
17-1/2" x 12-1/2"

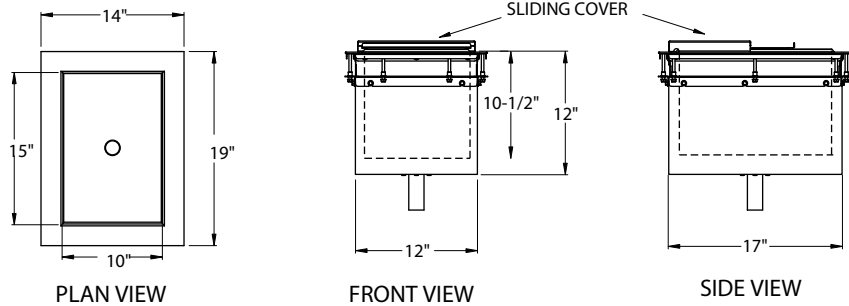

DI-IB18

Cut-out size:
17-1/2" x 18-1/2"

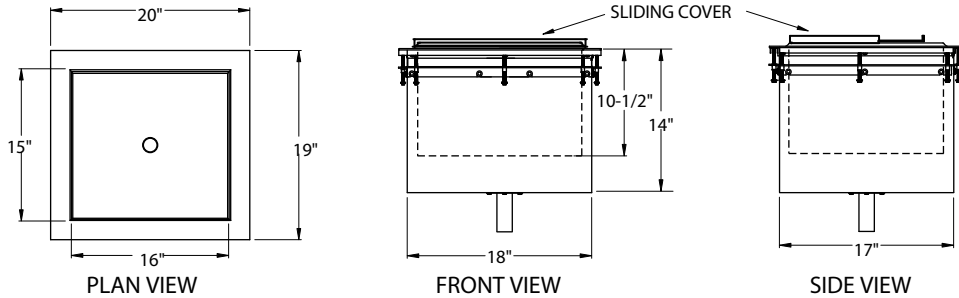

DI-IB24 or DI-IB24-CP10 (model DI-IB24-CP10 shown below)

Cut-out size:
17-1/2" x 24-1/2"

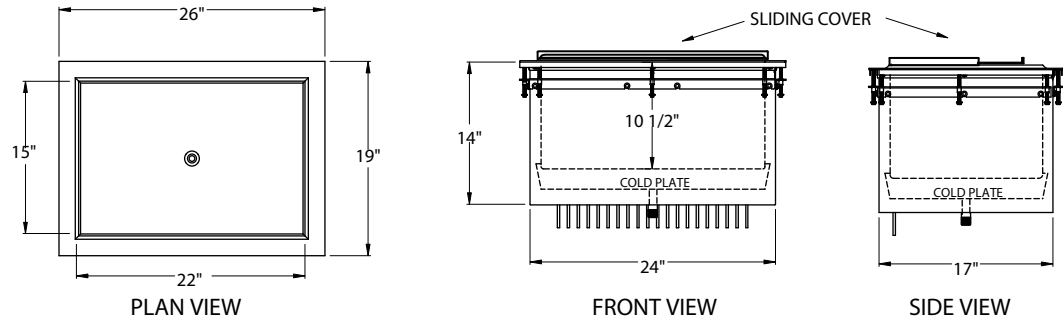

DI-IB30 or DI-IB30-CP10 (model DI-IB30-CP10 shown below)

Cut-out size:
17-1/2" x 30-1/2"

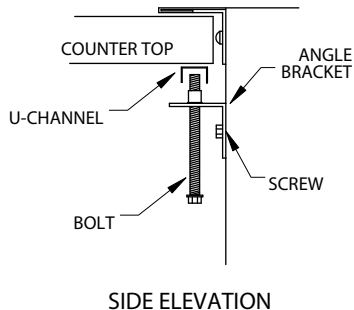
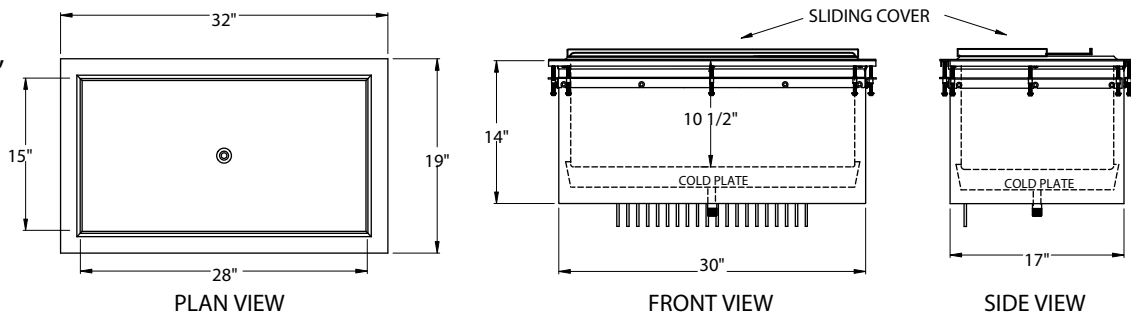

INSTALLATION INSTRUCTIONS*

1. Remove angle brackets from drop-in unit.
2. Place unit into appropriate size cut-out for specific model number used.
3. Replace angle brackets, firmly tighten screws.
4. Place U-channels on top of bolts.
5. Tighten each bolt evenly along U-channels.
6. To establish proper sanitation operation and to comply with NSF & health codes, this unit must be sealed to the surface to which it is mounted using an NSF listed sealant. Place a bead of sealant along outer edges of the mounting flange and remove any excessive amount. Make sure there are no gaps in the sealant as the intent is to prevent liquid spillage from adjacent surfaces from passing under inaccessible portions of the equipment.

*Provided hardware allows for unit to be removable as necessary



5400 N Michigan Rd • Saginaw, MI • 48604-9780
989.752.4275 • 800.748.0423 • Fax 989.752.4444
www.glastender.com

Printed in USA