

Project Name: \_\_\_\_\_ AIA#: \_\_\_\_\_

Model #: \_\_\_\_\_ Location: \_\_\_\_\_

SIS#: \_\_\_\_\_ Item #: \_\_\_\_\_ Quantity: \_\_\_\_\_



# Premium Heavy-Duty Automatic Slicer

**Precise - Powerful -  
Premium Construction**

*The all-new, heavy-duty S-Series line of premium slicers from Globe delivers precision, performance, industry-leading convenience, superior cleanability and lasting value.*



SG13A

**Removable Knife makes cleanup easier while providing more operator protection**



## Model

☐ SG13A (Advanced Model)

## Standard Features

- Patented anodized aluminum design & construction for quick and easy cleaning
- Patent-pending indexing system enables accurate and precise slice thickness adjustment up to 1-1/8"
- Patent-pending 4-hour cleaning notification cycle better ensures proper sanitation
- 13" steel knife with hardened edge provides quality slices and higher yield
- Tilting carriage accommodates up to 13.75" H, 8" dia., 11" W large products, like prosciutto, mortadella and bacon
- Advanced meat grip design for superior product hold
- 1/2 HP continuous use knife motor combined with the high efficiency knife drive system delivers optimum power
- No Voltage Release prevents inadvertent reactivation of slicer in the event of interlock or power interruption
- Interlock prevents slicer from operating without the knife cover in place
- Variable speed brushless auto mode motor delivers 3ft. lbs. of peak torque
- Patent-pending auto engagement system prevents slippage
- Lift lever to facilitate ease of cleaning
- Top mounted, removable sharpening system utilizes long-lasting synthetic diamond surfaces
- Patent-pending graphic user interface with Clear-Text LCD display provides operator messages, diagnostics and system information in English, Spanish and French
- Home Start – carriage must be in home position to start slicer
- Carriage tilt interlock – prevents knife exposure when carriage is tilted and prevents slicer from operating
- Return to Home feature returns carriage to home position when powering off motor
- Adjustable timer – shuts off slicer after inactivity
- Close to Stop – closing slicer gauge plate shuts off slicer
- 3 cut lengths and 4 speeds

## Warranty

- Two year parts and labor
- Lifetime warranty on sharpening stones

## Factory Installed Options

- KNIFE-RMV - Removable Knife includes removal tool
- CARRIAGE-RMV - Removable Carriage
- SSK - Stainless Steel Knife in lieu of Carbon Steel

## Optional Accessories

- S-FENCE - Food Fence
- S-VEGHOP - Vegetable Hopper
- S-SLAWTRAY - Slaw Tray
- S-LEGS - Extension Legs
- S-XDSLA - Extended Warranty
- SC-LARGE - Slicer Sanitation Cover

To select factory-installed options and accessories, see back



REVIT



AutoQuotes

Approved by: \_\_\_\_\_ Date: \_\_\_\_\_

2153 Dryden Rd., Dayton, OH 45439 | 937-299-5493 | 800-347-5423 | Fax: 937-299-4147 | [www.globefoodequip.com](http://www.globefoodequip.com)



## Premium Automatic Slicer Factory Installed Options

### Removable Carriage Package (CARRIAGE-RMV)

- Carriage easily lifts off slicer for cleaning
- Captive knob keeps carriage secure during slicing
- Carriage is removable without tilting, saving valuable space



### Removable Knife Package (KNIFE-RMV)

- Knife is secured in tool for operator protection
- Tool easily removes knife for more access under the knife and faster, easier cleanup
- Knife and removal tool are dish machine safe

### Stainless Steel Blade (SSK)

- For high acid content applications as found in vegetable and fruit preparation
- Helps protect slicer from corrosion caused by extreme moisture applications (meatrooms)
- Also recommended for tempered (semi-frozen) meat cutting



STAINLESS STEEL BLADE

## S-Series Advanced Model Features

- Home Start ensures the carriage is in home position in order for the slicer to start
- Patented 4-Hour Cleaning notification keeps operators on schedule for regular cleaning and sanitation
- Carriage Tilt Interlock prevents knife from running when the carriage is not secured
- Knife Time Out automatically shuts off the motor if the carriage remains idle for 30 seconds (timer can be adjusted to as little as 5 seconds)
- Close to Stop feature powers the slicer down after the slicer gauge plate is closed





## Premium Automatic Slicer Accessories



☐ **S-FENCEHI**  
High food fence  
(12.125" x 3")



☐ **S-FENCE**  
High food fence  
(12.125" x 1.125")



☐ **S-VEGHOP**  
Vegetable Hopper



☐ **SC-LARGE**  
Slicer Sanitation Cover



☐ **S-SLAWTRAY**  
Slaw Tray



☐ **S-LEGS**  
2.5" Extension Legs  
(set of 4)



☐ **S-XDSL A**  
Extended Warranty

## S-Series Features, Options & Accessory Guide

FEATURE	S13	S13A	SG13	SG13A
Knife Cover Interlock (Machine will not turn on)	■	■	■	■
Carriage Tilt Interlock (Machine will not turn on)			■	■
Home to Start (Carriage must be in Home position for blade to rotate)			■	■
Home Return			■	■
Time Out (Blade will stop running if not in use)*			■	■
Close to Stop (Blade will stop running when gauge plate is closed)			■	■
LCD Display		■	■	■
Site Diagnostics		■	■	■
System Counters		■	■	■
No Volt Release	■	■	■	■
Slicing Length Settings		2		3
Slicing Speed Settings		2		4
<b>CORR</b> - Correctional Package (Factory Option)	■	■	■	■
<b>KNIFE-RMV</b> - Removable Knife (Factory Option)	■	■	■	■
<b>CARRIAGE-RMV</b> - Removable Carriage (Factory Option)	■	■	■	■
<b>FROZEN</b> - Frozen Package (Factory Option)	■	■		

\*Time Out is programmable. Factory setting is 30 seconds.

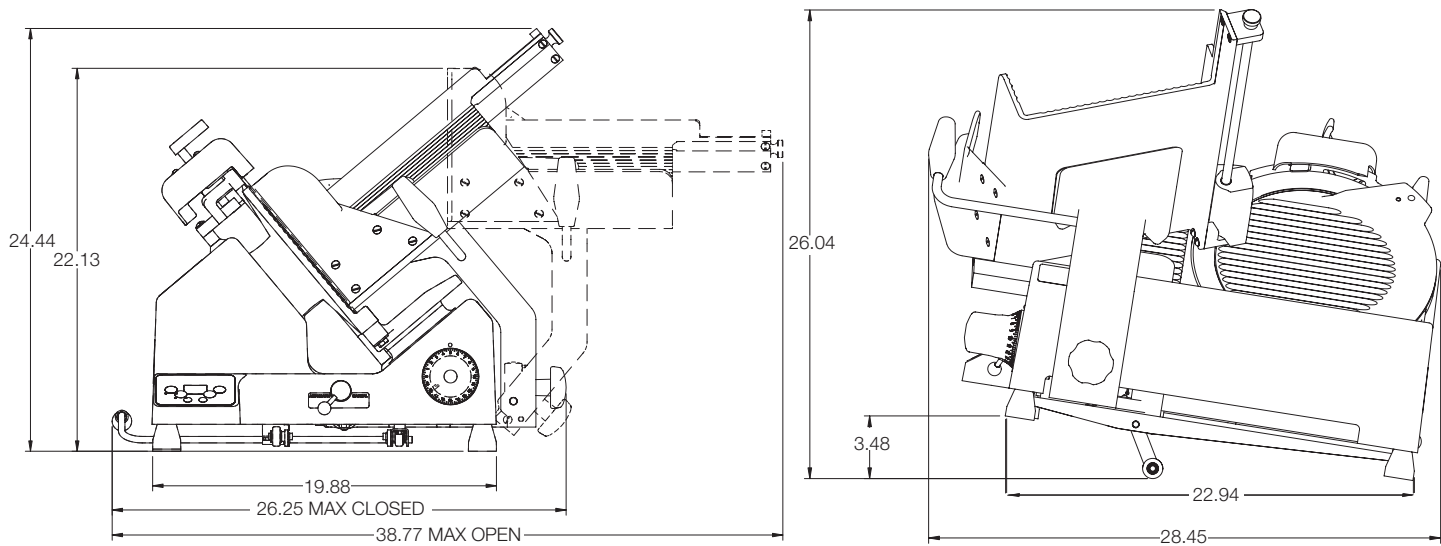

UNIT: Inches

Drawings available through KCL. [www.kclcad.com](http://www.kclcad.com)

### SPECIFICATIONS

Model	Motor	Volts	Amps	NEMA Plug Type	Drive Type	Slicing Vol. / Day	Cheese Slicing	Blade Diameter	Max Slice	Product Cutting Capacity		
										D (Diameter)	H (Height)	W (Width)
SG13A	1/2 HP	115-60-1	2.5	5-15	Poly-V Belt	All Day		13" (33.02 cm)	1-1/8" (2.857 cm)	8" (20.32 cm)	13.75" (35 cm)	11" (27.94 cm)
SG13A-05	1/2 HP	220-60-1	1.5	6-15P	Poly-V Belt	All Day		13" (33.02 cm)	1-1/8" (2.857 cm)	8" (20.32 cm)	13.75" (35 cm)	11" (27.94 cm)
SG13A-07	1/2 HP	220-50-1	1.5	CEE7/7	Poly-V Belt	All Day		13" (33.02 cm)	1-1/8" (2.857 cm)	8" (20.32 cm)	13.75" (35 cm)	11" (27.94 cm)

**Cord & Plug:** Attached 7 ft. flexible 3-wire cord with molded plug fits a grounded receptacle. **Please specify desired plug configuration when ordering.**

### DIMENSIONS | SHIPPING INFORMATION

Reinforced carton for shipping. The weight and dimensions of this reinforced carton are included below and may vary from shipment to shipment.

**Shipped on a pallet. Freight class 85.**

Model	Max Overall Dimensions	Net Weight	Shipping Dimensions	Shipping Weight
SG13A	38.7" W x 26.7" D x 20.9" H (98.5 cm x 68 cm x 53.1 cm)	127 lbs. (57.61 kg)	31.5" W x 31.5" D x 31.5" H (80 cm x 80 cm x 80 cm)	143 lbs. (64.86 kg)

### FACTORY INSTALLED OPTIONS:

- ☐ KNIFE-RMV - Removable Knife includes removal tool
- ☐ CARRIAGE-RMV - Removable Carriage
- ☐ SSK - Stainless steel knife in lieu of Carbon Steel

### OPTIONAL ACCESSORIES:

- ☐ S-FENCE - Food Fence
- ☐ S-VEGHOP - Vegetable Hopper
- ☐ SC-LARGE - Slicer Sanitation Cover
- ☐ S-SLAWTRAY - Slaw Tray
- ☐ S-LEGS - 2.5" Extension Legs
- ☐ S-XDSLA - Extended Warranty



KNIFE-RMV



CARRIAGE-RMV

Constructed of anodized aluminum with built-in Clear-Text display/control panel. 1/2 HP motor with overload protection and 13" hardened steel knife. Patent-pending indexing system with slice thickness adjustment up to 1-1/8". Top mounted removable sharpener with synthetic diamond stone wheel and plate. Tilting carriage accommodates up to 13.75" H, 8" dia., 11" W large products. Adjustable cut length and speed. Slicer is ETL listed. No Voltage Release and Knife Cover Interlock. Additional features include Home Start, Return to Home, Adjustable Timer, Close to Stop, Carriage Tilt Interlock and Clear-Text Display with services and operation/diagnostics and patent-pending 4-hour cleaning notification cycle. Two year parts and labor slicer warranty, lifetime warranty on sharpening stones.