



# SPEC SHEET

## KoolMore 48 in. High Wattage Commercial Food Strip Warmer with Toggle Controls and Cord - 120V, 1200W, UL Listed in Stainless-Steel

---

Model: KM-WSTRIP-48

### FEATURES

---

- Simple Toggle Control: Easy on/off switch for effortless operation.
- Powerful Heating: 1200W metal-sheathed element keeps food warm without drying.
- Food Clearance: 10" distance recommended for safe, even heating.
- Compact Design: 48" length, needs just 3" side clearance for airflow.
- Sturdy Construction: Lightweight 430 stainless steel built for durability.
- Thick Insulation: Minimizes heat loss, boosts efficiency, and cuts costs.
- Versatile Installation: Mount with chain or angle plate for flexibility.
- UL/NSF Listed & Warranty: Meets safety standards with a 1-year parts/labor warranty.



### CLOSE UP IMAGES

---



# TECHNICAL SPECS

## Dimensions

|                   |       |
|-------------------|-------|
| Length            | 48.18 |
| Width             | 6     |
| Height            | 2.75  |
| Weight Lbs        | 11.64 |
| Power Cord Length | 72    |

## Features & Materials

|                               |   |
|-------------------------------|---|
| Electrical Installation Type  | Plug-in   |
| Installation Type             | Chain or Angle Plate  |
| Number Of Elements            | 1   |
| Heating Element Wattage       | 1200W   |
| Control Type                  | Mechanical; Switch  |
| Control Location              | Front Panel   |
| Minimum Side Air Clearance In | 3 in.   |
| Included                      | Mounting Hardware   |
| Exterior Material             | Stainless-Steel 430   |
| Color Finish                  | Stainless-Steel   |
| Feature One                   | Simple on / off toggle control for easy operation   |
| Feature Two                   | Metal-sheathed element maintains peak serving temperatures without drying out food<br>Great for restaurants, cafeterias, and buffet lines |
| Feature Three                 |   |
| Feature Four                  | Durable yet light weight Stainless-Steel housing won't sag  |
| Feature Five                  | Thick insulation minimizes heat loss and directs heat where it's most needed  |

## Electric & Certifications

|                |   |
|----------------|---|
| Amps           | 10  |
| Hertz          | 60  |
| Phase          | 1   |
| Voltage        | 120   |
| Wattage        | 1200  |
| Plug Type      | NEMA 5-15P                                  |
| Certifications | UL Listed for Safety and NSF for Sanitation |

# Plan View

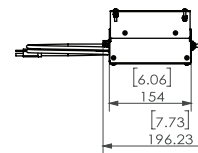
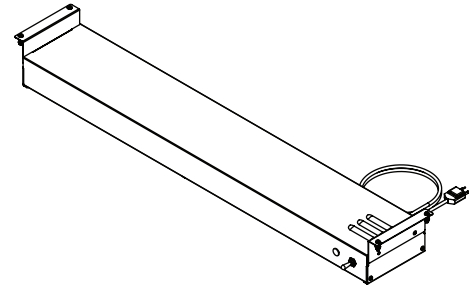
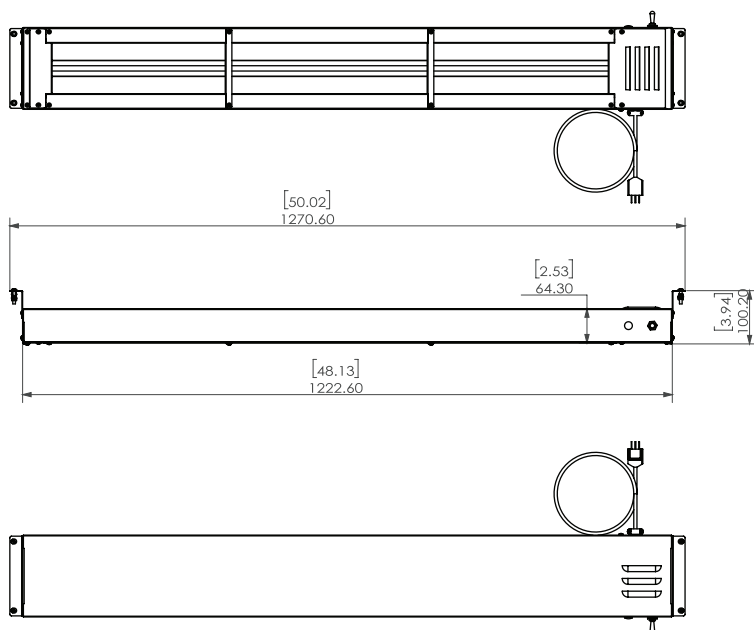

## CERTIFICATIONS



706 Eastern Parkway STE 1G, Brooklyn NY 11213  
718-576-6342  
info@koolmore.com