

## Cuisine Series Heavy Duty Spreaders

Project \_\_\_\_\_  
 Item \_\_\_\_\_  
 Quantity \_\_\_\_\_  
 CSI Section 11400  
 Approved \_\_\_\_\_  
 Date \_\_\_\_\_

### Models

- |          |          |          |          |
|----------|----------|----------|----------|
| • C12-SC | • C18-SC | • C24-SC | • C36-SC |
| • C12-SM | • C18-SM | • C24-SM | • C36-SM |
| • C12-SP | • C18-SP | • C24-SP | • C36-SP |



C24-SC Spreader Cabinet



C24-SM Modular Spreader



C24-SP Spreader Plate

### Standard Features

- Cabinet base (SC), modular top (SM), and spreader plate (SP) models
- Stainless steel top.
- Stainless steel front & sides.
- Stainless steel front rail
- 1 1/4" NPT front gas manifold
- Can be installed individually or in a battery
- 7" (178mm) high stainless steel stub back
- 6" (152mm) stainless steel adj. legs
- Modular unit (M) can be mounted on Polar Cuisine refrigerated base

### Options & Accessories

- Stainless steel back
- Single or double deck high shelf or back riser
- Stainless steel intermediate shelf for cabinet base
- Stainless steel door(s) for cabinet base units
- Extension for 1/9 pans
- Gas shut-off valves: 3/4", 1", 1 1/4" NPT (Specify)
- Gas regulator: 3/4", 1", 1 1/4" NPT (Specify)
- Gas flex hose w/ quick disconnect: 3/4", 1", 1 1/4" NPT (Specify)
- Rear gas connection: 3/4", 1", 1 1/4", 2" (C12-SP, C18-SP, C24-SC, C24-SP, C36-SC, C36-SP models only) (Specify)
- C18-SC with rear gas can have a 1 1/4" gas T
- C24-SC with rear gas can have a 2" gas T
- Full height stand for modular base with legs or casters
- Cabinet base mounting options:
- Set of (4) flanged feet (for fastening unit to the floor)
- Set of (4) 5" polyurethane non-marking swivel casters w/front brakes
- Set of (4) 6" swivel casters, w/front brakes

NOTE: Spreaders supplied with casters must be installed with an approved restraining device.

NOTE: Continuous front rail options are not available for spreaders.

### Specifications

Garland Cuisine Series Spreader Model \_\_\_\_\_  
 Stainless steel top, front, and sides. 6" (152mm) stainless steel legs with adjustable feet.



Cuisine Series Heavy Duty Spreaders

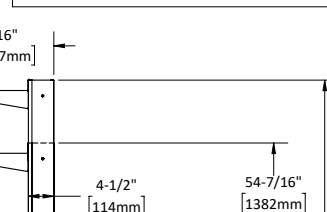
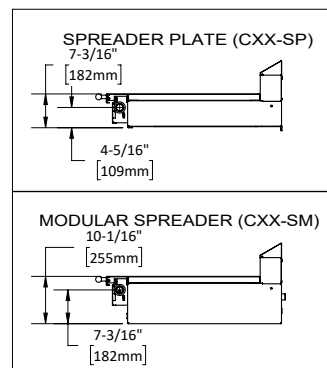
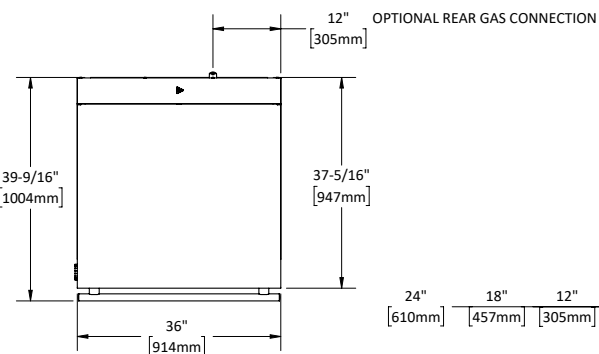

DAIS MOUNTING  
(NOT FOR CONVECTION BASE)

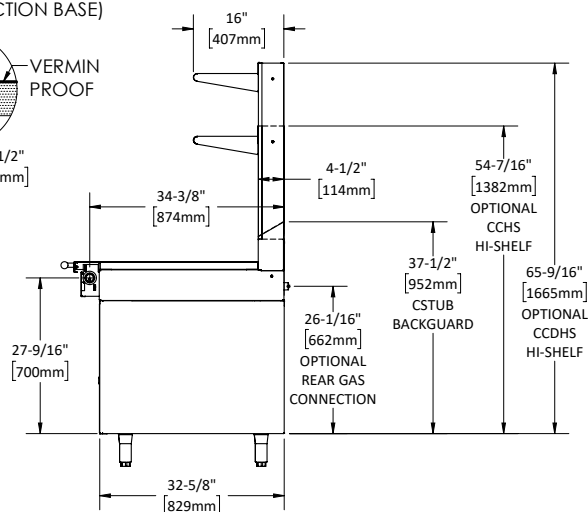
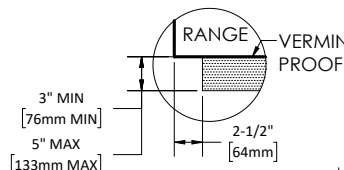
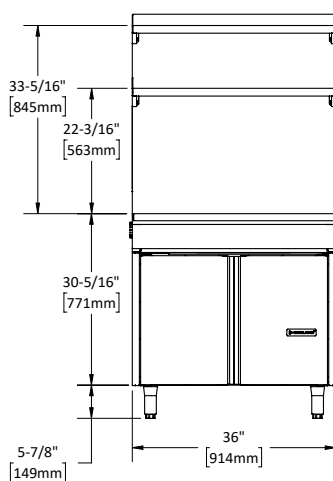

| Model # | Description               | Shipping |        |
|---------|---------------------------|----------|--------|
|         |                           | Cu Ft    | lbs/kg |
| C12-SP  | 12" Wide Spreader Plate   | 26       | 14/6   |
| C18-SP  | 18" Wide Spreader Plate   | 26       | 18/8   |
| C24-SP  | 24" Wide Spreader Plate   | 26       | 24/11  |
| C36-SP  | 36" Wide Spreader Plate   | 30       | 38/17  |
| C12-SM  | 12" Wide Modular Spreader | 26       | 17/8   |
| C18-SM  | 18" Wide Modular Spreader | 26       | 22/10  |
| C24-SM  | 24" Wide Modular Spreader | 26       | 29/13  |
| C36-SM  | 36" Wide Modular Spreader | 30       | 45/20  |
| C12-SC  | 12" Wide/Open Cabinet     | 35       | 145/66 |
| C18-SC  | 18" Wide/Open Cabinet     | 35       | 152/69 |
| C24-SC  | 24" Wide/Open Cabinet     | 35       | 162/73 |
| C36-SC  | 36" Wide/Open Cabinet     | 53       | 205/93 |

| Exterior Dimensions         |                 |                 |                 |
|-----------------------------|-----------------|-----------------|-----------------|
| Product                     | C12-SC          | C18-SC          | C36-SP          |
| Width                       | 12" (305mm)     | 18" (457mm)     | 36" (914mm)     |
| Depth                       | 37-7/8" (962mm) | 37-7/8" (962mm) | 37-7/8" (962mm) |
| Height w/o Legs             | 30" (762mm)     | 30" (762mm)     | 30" (762mm)     |
| Height w/Legs               | 36" (914mm)     | 36" (914mm)     | 36" (914mm)     |
| Cabinet Interior Dimensions |                 |                 |                 |
| Width                       | 9-1/2" (241mm)  | 15-1/2" (394mm) | 32-1/4" (819mm) |
| Depth                       | 28-1/2" (724mm) | 28-1/2" (724mm) | 31" (787mm)     |
| Height                      | 19-1/2" (495mm) | 19-1/2" (495mm) | 20-1/2" (521mm) |

| Combustible Wall Clearance |          |
|----------------------------|----------|
| Sides                      | Back     |
| 0" (0mm)                   | 0" (0mm) |

Garland reserves the right to make changes to the design or specifications without prior notice.

Garland Commercial Ranges Ltd.  
1177 Kamato Road,  
Mississauga, Ontario  
L4W 1X4 CANADA

General Inquires 1-905-624-0260  
USA Sales, Parts and Service 1-800-424-2411  
Canadian Sales 1-888-442-7526  
Canada or USA Parts/Service 1-800-427-6668

[www.garland-group.com](http://www.garland-group.com)  
7917  
01/24

