



REFRIGERATORS & FREEZERS

WORKTOP SIDE MOUNT FREEZER MODELS 9200F-290

Self-contained stainless steel worktop freezer with 3" high backsplash. Electronically controlled natural R290 refrigeration system with Randell mullion blower coil. Stainless-steel hinged louver, foamed in place urethane insulation, condensate evaporator, 6" high adjustable legs and cordset for 115V operation.

SHORT FORM SPEC: Randell 9200F series model worktop freezer base with self-contained refrigeration system. Top to be 1 piece die formed stainless steel with corrosion resistant exterior body. Includes Randell evaporator blower coil fitted to base. Base interior ends and door openings shall be high impact ABS plastic with coved corner aluminum interior to form bottom, back and top of cabinet. Base cabinet door to have ABS liner and include press-fit magnetic gaskets for positive sealing to ABS formed door opening frame. Unit to be shipped on standard 6" adjustable legs mounted to full length channel frame assembly allowing movement of legs to avoid floor obstacles. cUL, UL, NSF.

AVAILABLE MODELS:

9215F-290
9205F-290

STANDARD FEATURES:

- Side mounted compressor with mullion coil provides balanced cooling, and "full depth" usable interior space
- SNAP compliant R290 HC refrigerant
- Automatic condensate evaporator
- Exterior stainless steel top & ends
- Foamed in place "CFC free" urethane insulation
- Once-piece stainless steel worktop with 3" high integral backsplash
- Visible externally mounted electronic controller features automatic adaptive defrost
- 6" high adjustable legs
- 8' cord and plug for 115 volt operation
- Self-closing doors with press-fit magnetic gaskets

CABINET EXTERIOR: Cabinet body is constructed of all metal. Cabinet top to be one piece die-formed 20 gauge stainless steel with 1 1/2" high square nosing. Top to have 3" high integral backsplash. All units are standard with stainless steel ends. Door openings to be ABS and contain magnetic strip for positive sealing of gaskets. Louver is stainless steel, hinged for easy access to cleaning condenser coil. Work surface to be at 36" work height with unit on standard 6" high adjustable legs.

CABINET INTERIOR: Unit base interior to be ABS thermoplastic at ends only. Anodized aluminum base liner to be coved cornered to form interior bottom, back and top meeting N.S.F. standard #7. One baked enamel finished shelf provided behind door. Unit insulated with a minimum of 2.5" of CFC free, foamed in place polyurethane.

DOORS: Easy to grasp recessed handles, foamed in place insulation, press fit magnetic gaskets - (designed for installation & removal without tools), and deep draw ABS interior liner for maximum insulation value. Doors mounted on heavy duty concealed stainless steel hinges with bronze pivot pin in nylon bushing.

REFRIGERATION: The system will utilize state of the art, energy efficient R290 compressor system with (0) ozone depletion potential (ODP) and (3) global warming potential meeting SNAP (CA) compliance. System is controlled by an externally visible electronic controller metered using capillary tube system. Front-breathing side mounted compressor housing design allows maximum airflow, heat removal and easy maintenance of the condensing unit. Mullion coil, is coated to resist corrosion, and offers balanced air flow while allowing use of the full depth interior for maximum product storage. Units totally prewired and to be supplied with 8' cordset (NEMA 5-15P) for 115V operation.

Certifications:

PROJECT NAME:	
LOCATION:	
ITEM NO:	
QTY:	
MODEL NO:	
AIA NO:	
SIS NO:	
CSI SECTION:	11400



Model 9205F-290 shown

OPTIONS/ACCESSORIES:

Stainless Steel Finished Back
Tray Racks for 18"X26" Sheet Pans (24" or 27" Openings Only)
Casters
Deck Mount Overshelves; Single/Double
Remove Backsplash
Stainless Steel Door Liner
Stainless Steel Interior
Stainless Steel Door Threshold
Gasket Guard(s)
Cutting Board
Door/Drawer Locks
Additional Shelves

ADDITIONAL RESOURCES:

[Request A Quote](#)

[Sales Tools](#)

[Find A Rep](#)

[KCL AutoCAD/Revit](#)

Refrigerators & Freezers
SP SHT2506 RevA

06/25

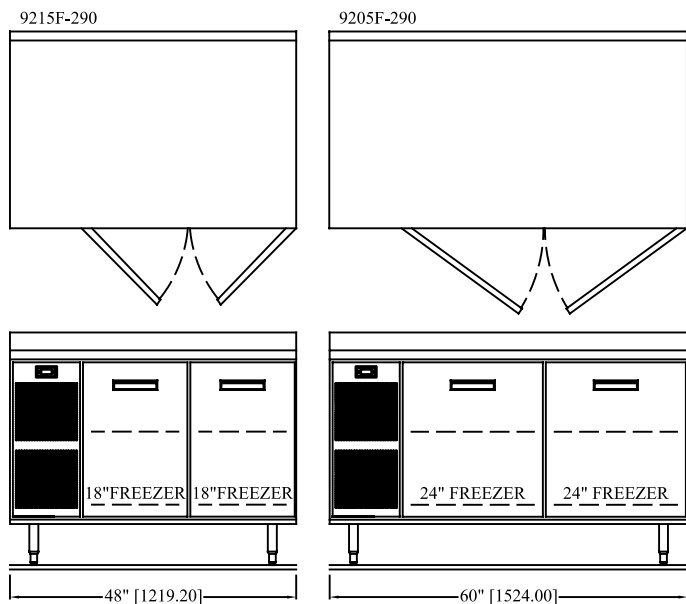

Model	L	W	H*	Doors	Storage Cu. Ft.	HP	Volt	Amps	NEMA	Ship Wt.
9215F-290	48"	33"	36"	(2)18"	11.58	1/2	115/60/1	5.25	5-15P	325
9205F-290	60"	33"	36"	(1)21", (1) 27"	16.21	1/2	115/60/1	5.25	5-15P	450

*When ordering casters, 6" casters equal 35" height; 4" casters equal 33" height

DOOR OPENING SIZES	CLEARANCES THROUGH DOOR		ACCEPTS SHEET PAN SLIDES
	LT. TO RT.	TOP TO BOTTOM	
18"	13 1/4"	22"	No
24"	19 1/4"	22"	Yes

DIMENSIONAL DETAIL:

