

# Cleveland

Project \_\_\_\_\_  
Item \_\_\_\_\_  
Quantity \_\_\_\_\_  
FCSI Section 11400 \_\_\_\_\_  
Approved \_\_\_\_\_  
Date \_\_\_\_\_

## MINI MVP TILT SKILLET

ELECTRIC TABLE TYPE, RECTANGULAR,  
10 GALLON (40 LITER) WORKING CAPACITY

### Models

- SET-10



Shown with optional Double Pantry Faucet (DPK24)



Shown with optional Support Stand (ST28) and Double Pantry Faucet (DPK24)

### Short Form Specifications

Shall be CLEVELAND 10 Gallons (40 liters) Model SET-10 \_\_\_\_\_; \_\_\_\_\_ KW \_\_\_\_\_ Volt, mini tilt skillet of type 304 Stainless Steel Construction, with #4 Finish. Electric Heating Elements cast integrally onto 1.25" / 32mm thick aluminum blocks and securely clamped beneath cooking surface. Bead-Blast-Textured Cooking Surface. Complete with Thermostatic, Safety and Main Power Controls with Lighted Indicators. For Table Top Mounting. Spring Assist Cover.

### Standard Features

- Heating Element are cast integrally into 1.25" (32mm) thick aluminum blocks which are securely camped to the underside of the cooking surface, providing even heat distribution and energy efficiency with rapid heat-up
- Stainless Steel Cooking Surface is structurally braced to prevent warping
- Meets IPX6 water rating guidelines
- Bead-blast Textured Cooking Surface Finish to reduce sticking
- Heavy Duty Stainless Steel Construction, with #4 Finish
- Easydial style controls with time and temperature controls and display, 3 cooking modes, built-in diagnostics and removable core temperature probe
- Solid State Temperature Control conveniently located in a Drip Proof Side Console. Temperature Controlled from 190°F (88°C) to 425°F (220°C)
- Sanitary Base Mounting for Table Top or Stand Mounted Installation
- Standard 208 Volts, 60 Hz, 3 Phase, 3 Wire
- Spring Assist Cover
- Removable Core Temperature Probe
- Typical approvals include UL, CSA, and NSF
- 12 gallon (45 liter) capacity to rim, 10 gallon (40 liter) working capacity

### Options & Accessories

- Poaching Pans (PP)
- Vegetable Steamer (VS)
- Double or Single Water Faucet with Swing Spout (DPK24) or (SPK24)
- Stainless Steel Support Stands (ST28) with Sliding Drain Drawer and Splash Screen
- Single phase option (SPH)
- Food Strainer (SF10)
- Fry Baskets (FB10) (1 each)
- 1.5" Tangent Draw-off (38mm) (TD1.5)
- 240 volt, 60 Hz., 3 phase (VOSK1)
- 340-415 volt, 50 Hz., 3 phase (VOSK2)

KE004046-90

# Cleveland

Braising Pans / Tilting Skillets

## CAPACITIES

In 4 oz. servings. Other sizes may be calculated.  
10 gallons / 40 Liters ..... 320

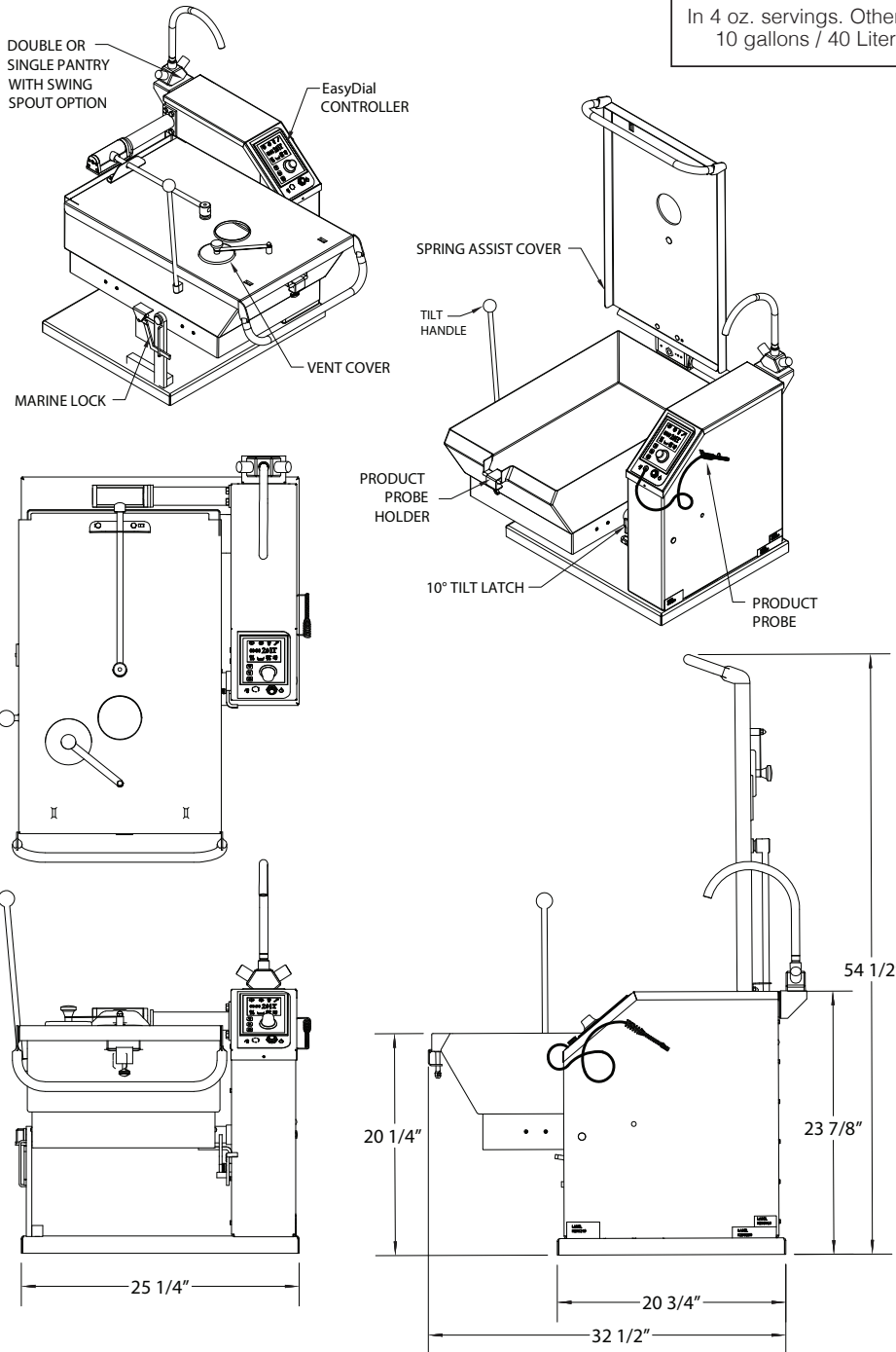

		ELECTRIC ⚡						CLEARANCE		
		208 VOLTS		240 VOLTS		220 /380 VOLTS		RIGHT = 3.00"		
		AMPS		AMPS		AMPS		LEFT = 0"		
GALS	LITERS	1 PH	3 PH	1 PH	3 PH	1 PH	3 PH	REAR = 1.00"		
10	40	7.4	35.4	20.5	7.8	32.7	18.9	6.5	N/A	9.9

DUAL VOLTAGE OF 220/380 SHOWN ON CHART REQUIRES A FOUR WIRE, THREE PHASE ELECTRICAL SUPPLY.

**Shipping Weights & Dimensions**  
Model - SET-10  
Weight - 212 lbs  
Width - 34"  
Depth - 34"  
Height - 34"

### NOTES:

Cleveland Range reserves right of design improvement or modification, as warranted.  
Many regional, state and local codes exist and it is the responsibility of the owner and installer to comply with the codes.  
Cleveland Range equipment is built to comply with applicable standards for manufacturers. Included among those approval agencies are U.L., NSF, CGA, CSA, ETL and others.

(NOT TO SCALE)

760 Beta Drive, Unit D  
Mayfield Village, Ohio 44143

Tel 1.216.481.4900  
Fax 1.216.481.3782  
Email steam@clevelandrange.com

www.clevelandrange.com  
Section 9, Page 4  
5671A 07 / 2022

Timeless Quality, Trusted For Life®