



# Underbar Corner Drain Boards

***Stainless Steel Underbar Corner Drain Board  
with Die Wall and Base***



Use your smart phone to  
scan the above QR code to  
visit our website:  
[www.bk-resources.com](http://www.bk-resources.com)

## Certifications:



## Features:

- 18" or 21" Available
- Stamped & Pitched Drainboards
- Includes: BKDR-15CP Drain
- Removable Front panel on Base
- 41" Standard Height

## Material:

- T-304 18 ga. Stainless Steel
- Stainless Steel Die Wall and Base

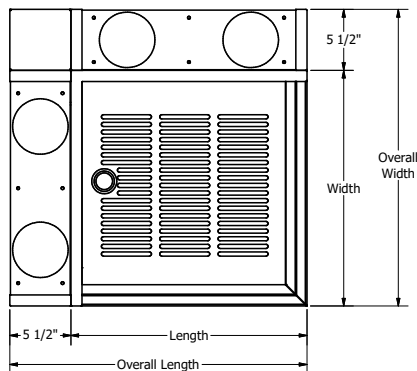

| Part Number | Unit Size<br>(l x w x h) | Product Weight<br>(lbs) |
|-------------|--------------------------|-------------------------|
| UBDW-18-CDB | 18" x 18" x 41"          | -                       |
| UBDW-21-CDB | 21" x 21" x 41"          | -                       |

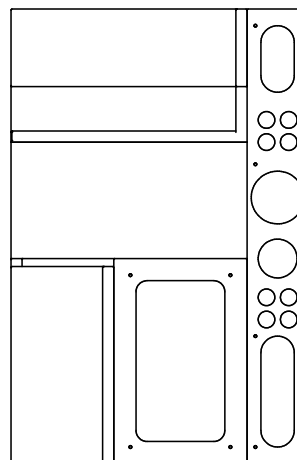
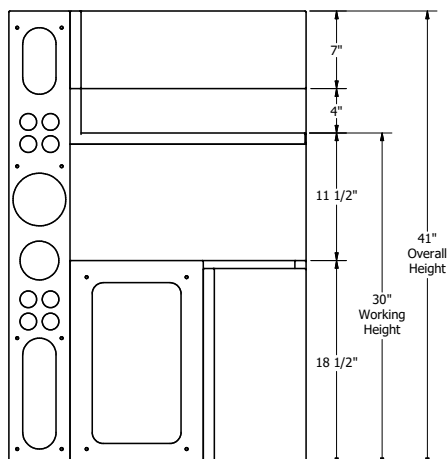

PRODUCT DATA SHEET

BK RESOURCES

