

## "PBHS-0909-SSLR" PRO-BOWL HAND SINKS

*Wall Mount, (1) 9"x9"x5" Deep Bowl - Space Saver w/Side Splashes*

### FEATURES:

- One Piece Deep Drawn Bowl
- All Sink Bowls Have Large Liberal Radii Corners
- Includes Basket Drain
- Splash Mount Faucet Holes 4" On-Center
- Stainless Steel Side Splashes Included

### SPECIFICATIONS:

- Bowl: Stainless Steel Tops Are TIG Welded, Exposed Welds Are Polished To Match Adjacent Surface
- Bowl: Type 300 Stainless Steel Polish, Satin Finish
- Bracket: Type 300 Stainless Steel Polish, Satin Finish
- Drain: 2" Drain Opening, 1-7/8" Drain Size With 1-1/2" NPS Outlet Connection

### CERTIFICATIONS:



PBHS-W-0909-SSLR

### ACCESSORIES

#### MODEL

Faucets

ADA Wrist Blades

Towel Dispenser

Lever Wastes

Over Flows

P-Traps

### "PBHS-0909-SSLR" PRO-BOWL HAND SINKS

MODEL	BOWL SIZE (L X W X H)	OVERALL SINK SIZE (L X W X H)	DRAIN SIZE	FAUCET	WEIGHT (LBS)
PBHS-W-0909-SSLR	9"x9"x5"	12"x14-1/2"x12-7/16"	1-7/8"	N/A	10
PBHS-W-0909-P-SSLR	9"x9"x5"	12"x14-1/2"x12-7/16"	1-7/8"	PBF-4-SLF	10

ALL DIMENSIONS ARE TYPICAL. TOLERANCE +/- .500". JOHN BOOS & CO. RESERVES THE RIGHT TO CHANGE SPECIFICATIONS WITHOUT NOTICE.

# DETAILED SPECIFICATIONS

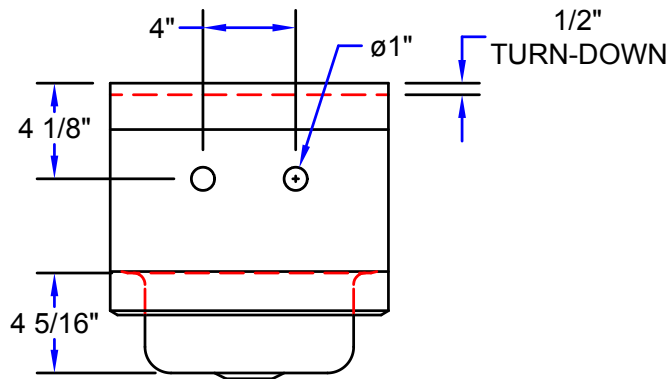
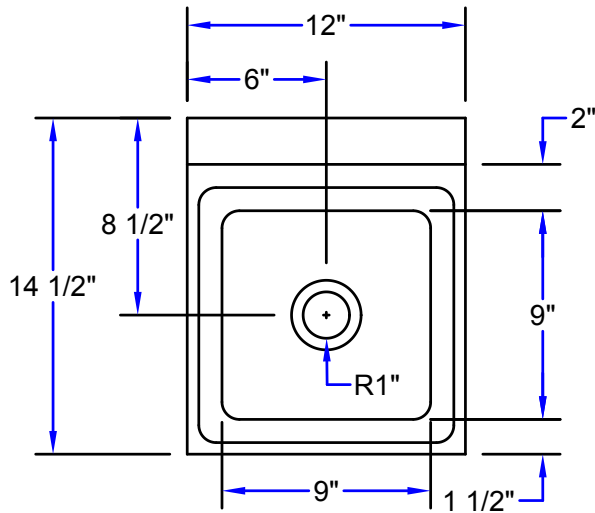

MOUNTING BRACKET

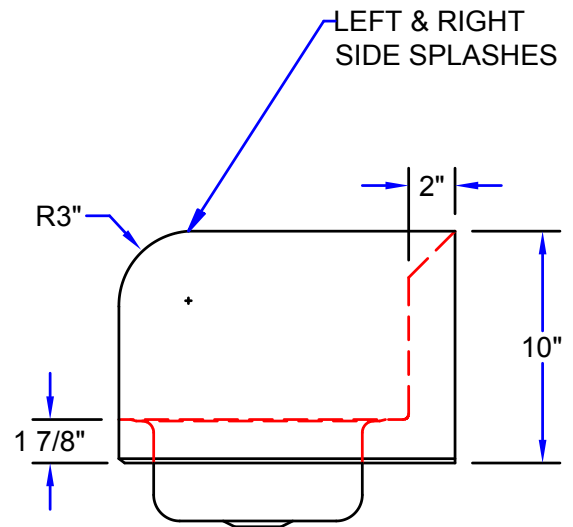
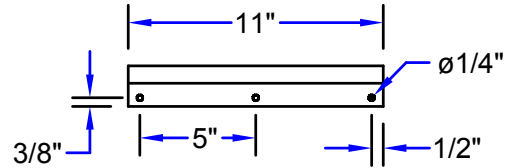

## "PBHS-0909-SSLR" PRO-BOWL HAND SINKS

MODEL	BOWL SIZE (L X W X H)	OVERALL SINK SIZE (L X W X H)	DRAIN SIZE	FAUCET	WEIGHT (LBS)
PBHS-W-0909-SSLR	9"x9"x5"	12"x14-1/2"x12-7/16"	1-7/8"	N/A	10
PBHS-W-0909-P-SSLR	9"x9"x5"	12"x14-1/2"x12-7/16"	1-7/8"	PBF-4-SLF	10

ALL DIMENSIONS ARE TYPICAL. TOLERANCE +/- .500". JOHN BOOS & CO. RESERVES THE RIGHT TO CHANGE SPECIFICATIONS WITHOUT NOTICE.